

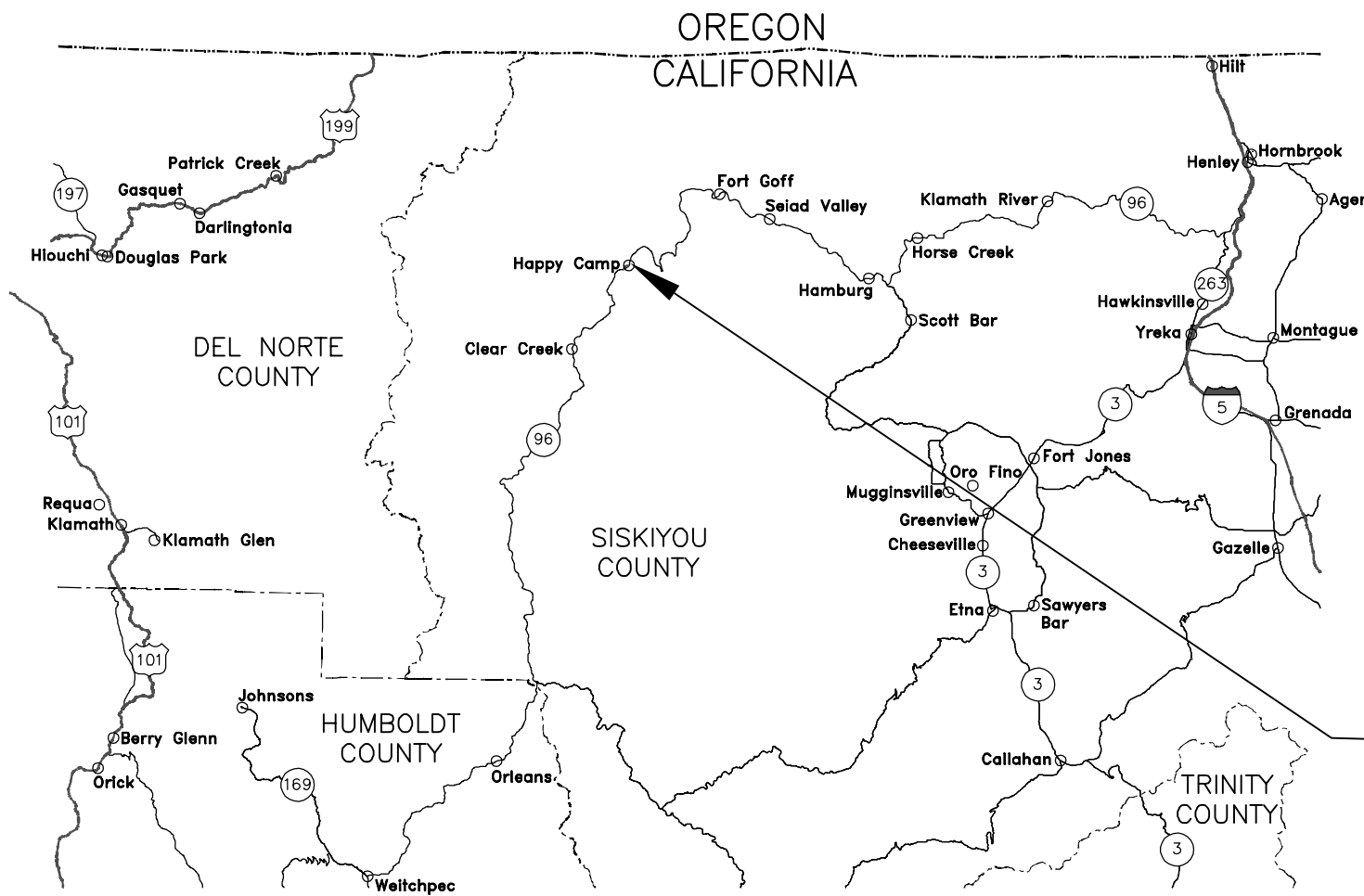

PLANS FOR CONSTRUCTION OF  
 JACOBS WAY WELLNESS CENTER  
 PARKING LOT PROJECT  
 KARUK TRIBE  
 HAPPY CAMP, CALIFORNIA  
 PROJECT NO. J52555-0108.10

PROJECT INDEX TO SHEETS	
SHEET NUMBER	SHEET TITLE
1	TITLE SHEET
2	PROJECT LOCATION MAP
3	GENERAL NOTES
4	QUANTITIES
5	CONSTRUCTION PLAN
6	GRADING PLAN
7	SIGN POST DETAILS
8	MISC. DETAILS



**ROADWAY LEGEND**

	INTERSTATE ROUTE MARKER
	U.S. ROUTE MARKER
	STATE ROUTE MARKER

PROJECT DESCRIPTION: GRADING,  
 AGGREGATE, PAVING, PERMANENT TRAFFIC  
 CONTROL

PROJECT AREA = 5,700 SF

UTILITY CONTACTS		
UTILITY	COMPANY NAME	CONTACT
WATER	HAPPY CAMP WATER DISTRICT	(530) 493-5106
SEWER	HAPPY CAMP SANITARY DISTRICT	(530) 493-5293
POWER	PACIFIC POWER	(888) 221-7070
GAS	PACIFIC POWER	(888) 221-7070

**811 NOTICE!**  
 TWO WORKING DAYS BEFORE  
 YOU DIG CALL: 811  
 WWW.BLUESTAKES.ORG

Know what's below.  
**Call before you dig.**

EXISTING UTILITIES ARE SHOWN ON PLANS FOR THE CONVENIENCE OF THE CONTRACTOR ONLY. THE CONTRACTOR IS RESPONSIBLE FOR THE PROTECTION OF ALL UTILITIES. THE ENGINEER BEARS NO RESPONSIBILITY FOR UTILITIES NOT SHOWN OR SHOWN INCORRECTLY.

**JACOBS WAY WCPL**  
 KARUK TRIBE  
 HAPPY CAMP, CA  
**TITLE SHEET**

**RED PLAINS**  
 PROFESSIONAL, INC.  
 CIVIL ENGINEERING • GIS • PLANNING • CONSTRUCTION MANAGEMENT

RED PLAINS PROFESSIONAL, INC.  
 2103 NE 129TH STREET  
 SUITE 201  
 VANCOUVER, WA. 98686  
 TEL: (360) 448-7999  
 FAX: (360) 258-0274  
 www.red-plains.com

NO.	DATE	REVISIONS DESCRIPTION

Z:\PROJECTS\70006 - KARUK - T011 HAPPY CAMP WCPL\16 CADD\PRODUCTION\TITLE SHEET.DWG 6/29/2020 5:18:50 PM by:kevin.ortega

Z:\PROJECTS\70006 - KARUK - T011 HAPPY CAMP WCPF\16 CADD\PRODUCTION\TITLE SHEET.DWG 6/29/2020 5:18:53 PM by:kevin.ortega

PROJECT LOCATION MAP

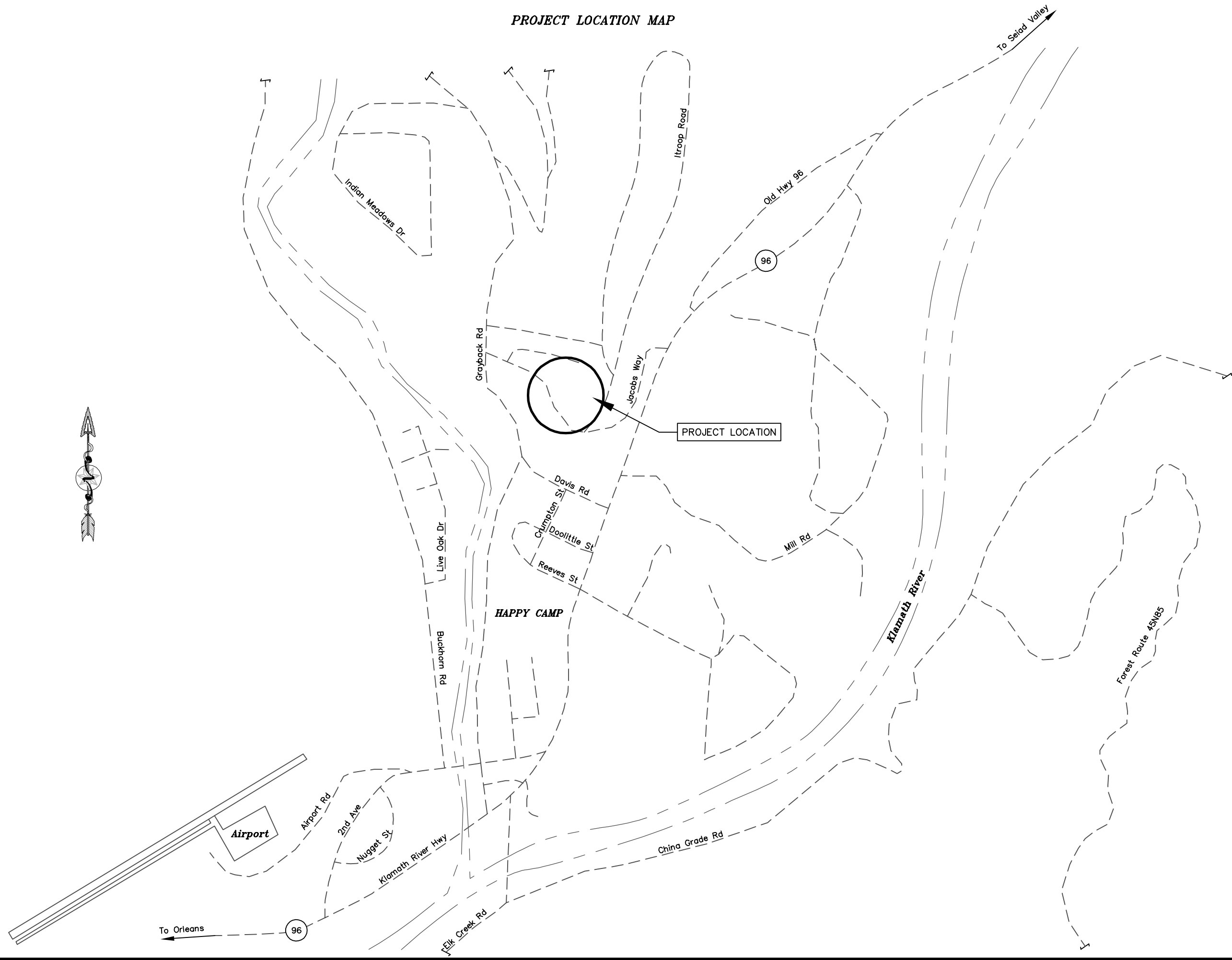

**JACOBS WAY WCPL**  
 KARUK TRIBE  
 JACOBS WAY, HAPPY CAMP, CA  
**PROJECT LOCATION MAP**

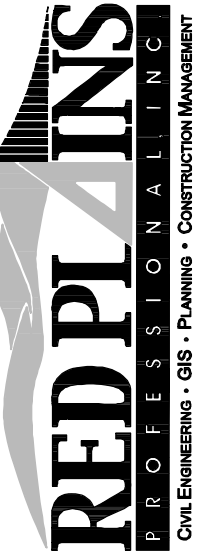

RED PLAINS PROFESSIONAL, INC.  
 2103 NE 129TH STREET  
 SUITE 201  
 VANCOUVER, WA. 98686  
 TEL: (360) 448-7999  
 FAX: (360) 258-0274  
 www.red-plains.com

NO.	DATE	REVISIONS	DESCRIPTION

PROJ. 70006  
 SHT. 2

GENERAL NOTES

STANDARD SPECIFICATION FOR CONSTRUCTION OF ROADS AND BRIDGE OF FEDERAL HIGHWAY PROJECTS (FP-14 U.S. CUSTOMARY UNITS) SHALL PREVAIL.

THE CONTRACTOR SHALL BE RESPONSIBLE FOR VERIFYING THE LOCATIONS OF ALL UTILITIES. THIS WORK WILL NOT BE MEASURED OR PAID FOR DIRECTLY BUT WILL BE CONSIDERED A SUBSIDIARY OBLIGATION OF THE CONTRACT. UTILITIES SUCH AS TELEPHONE AND POWER LINES SHALL BE WORKED AROUND. ANY DAMAGE TO THESE UTILITIES SHALL BE THE RESPONSIBILITY OF THE CONTRACTOR.







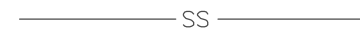

THE CONTRACTOR SHALL BE RESPONSIBLE FOR THE SIGNING AND MAINTENANCE OF TRAFFIC DETOURS DURING CONSTRUCTION IN ACCORDANCE WITH FP-14, SECTION 156 AND 635, AND THE SPECIAL CONTRACT REQUIREMENTS.

THE CONTRACTOR SHALL BE RESPONSIBLE FOR ALL QUALITY CONTROL WORK IN ACCORDANCE WITH FP-14 AND WITH DETAILED REQUIREMENTS IN THE SPECIAL CONTRACT REQUIREMENTS.

THE CONTRACTOR SHALL BE RESPONSIBLE FOR LOCATING MATERIALS SOURCES FOR THIS PROJECT AS WELL AS MEETING ALL REQUIREMENTS OF SECTION 105 AND 107 OF THE FP-14 AND THE SPECIAL CONTRACT REQUIREMENTS. THE CONTRACTOR SHALL ALSO BE RESPONSIBLE FOR SECURING ALL PERMITS FOR THE USE OF THE SOURCE AND PROVIDING COPIES OF THE DOCUMENTS TO THE PROJECT C.O.R.

THE CONTRACTOR SHALL BE RESPONSIBLE FOR OBTAINING ANY NECESSARY PERMITS FROM THE COUNTY OR STATE IF WORK IS TO BE PERFORM WITHIN THEIR RIGHT-OF-WAY PRIOR TO ANY CONSTRUCTION ACTIVITIES.

LEGEND

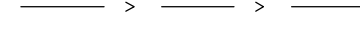
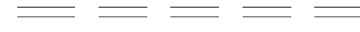
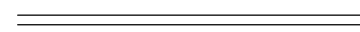
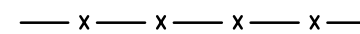
	FO	EXISTING FIBER OPTIC LINE
	SS	EXISTING SEWER LINE
	W	EXISTING WATER LINE
		EXISTING SEWER MANHOLE
		EXISTING FIRE HYDRANT
		EXISTING WATER METER
		EXISTING TREE
		PROPOSED ASPHALT
		PROPOSED CONCRETE
		DRAINAGE DIRECTION
		EXISTING GROUND CONTOURS
		FINISHED GROUND CONTOURS
		SILT FENCE

ABBREVIATIONS

A.B.C.	AGGREGATE BASE COURSE
BLDG	BUILDING
BM	BENCH MARK
C&G	CURB AND GUTTER
CL OR CL	CENTERLINE
CONC.	CONCRETE
CRL	CONSTRUCTION REFERENCE LINE
C.Y.	CUBIC YARD
DR.	DRIVE
EA.	EACH
EG	EXISTING GRADE
EL OR ELEV.	ELEVATION
EOA	EDGE OF ASPHALT
ENC	END FULL SUPER
EVCS	END VERTICAL CURVE STATION
EVCE	END VERTICAL CURVE ELEVATION
EX	EXISTING
FT.	FEET
FG	FINISHED GRADE
FL OR FL	FLOW LINE
GFL	GUTTER FLOW LINE ELEVATION
H.P.	HIGH POINT
HORZ.	HORIZONTAL
LVC	LENGTH OF VERTICAL CURVE
L.F.	LINEAR FEET
L.P.	LOW POINT
LT	LEFT
MTN.	MOUNTAIN
UGG	UNDERGROUND GAS
TUG	TELEPHONE UNDERGROUND
RT	RIGHT
RTE.	ROUTE
ROW OR R/W	RIGHT OF WAY
SEC.	SECTION
STR.	STRUCTURE
S.Y.	SQUARE YARD
TRANS.	TRANSITION
VERT.	VERTICAL
N/A	NOT APPLICABLE

**JACOBS WAY WCPL**  
 KARUK TRIBE  
 JACOBS WAY, HAPPY CAMP, CA  
**GENERAL NOTES**



RED PLAINS PROFESSIONAL, INC.  
 2103 NE 129TH STREET  
 SUITE 201  
 VANCOUVER, WA. 98686  
 TEL: (360) 448-7999  
 FAX: (360) 258-0274  
 www.red-plains.com

NO.	DATE	REVISIONS DESCRIPTION

Z:\PROJECTS\70006 - KARUK - T011 HAPPY CAMP WCPL\16 CADD\PRODUCTION\TITLE SHEET.DWG 6/29/2020 5:18:54 PM by:kevin.ortega

Z:\PROJECTS\70006 - KARUK - T011 HAPPY CAMP WCPF\16 CADD\PRODUCTION\TITLE SHEET.DWG 6/29/2020 5:18:55 PM by:kevin.ortega

QUANTITIES LIST				
ITEM NO.	ITEM DESCRIPTION	NOTES	QUANTITY	UNIT
15101	MOBILIZATION		1	L.S.
15201	CONSTRUCTION SURVEY AND STAKING		1	L.S.
15401	CONTRACTOR SAMPLING AND TESTING		1	L.S.
15701	SOIL EROSION CONTROL		1	L.S.
20101	CLEARING AND GRUBBING		1	L.S.
20303	REMOVAL OF CONCRETE		19	S.Y.
20315	SAWCUTTING PAVEMENT		234	L.F.
20401	ROADWAY EXCAVATION		173	C.Y.
30102	ROADWAY AGGREGATE BASE, METHOD 2		173.4	TON
40301	HOT ASPHALT CONCRETE PAVEMENT, TYPE 1		86	TON
60901	CURB AND GUTTER, CONCRETE		35	L.F.
60906	VALLEY GUTTER, CONCRETE		32	S.Y.
60915	WHEELSTOP, CONCRETE		11	EA.
63301	SIGN SYSTEM		2	EA.
63401	PAVEMENT MARKING, TYPE K, SOLID		390	L.F.
63403	PAVEMENT MARKING, TYPE K, STRAIGHT ARROW		2	EA.
63501	TEMPORARY TRAFFIC CONTROL		1	L.S.
63612	LUMINAIRE, SOLAR		2	EA.

**JACOBS WAY WCPL**  
 KARUK TRIBE  
 JACOBS WAY, HAPPY CAMP, CA  
**QUANTITIES**



RED PLAINS PROFESSIONAL, INC.  
 2103 NE 129TH STREET  
 SUITE 201  
 VANCOUVER, WA. 98686  
 TEL: (360) 448-7999  
 FAX: (360) 258-0274  
 www.red-plains.com

NO.	DATE	REVISIONS DESCRIPTION

PROJ. 70006  
 SHT. 4

Z:\PROJECTS\70006 - KARUK - T011 HAPPY CAMP WCPFF\16 CADD\PRODUCTION\HC\_SITE.DWG 6/29/2020 5:19:14 PM by:kevin.ortega

CONTROL POINT #2  
 ELEV: 1258.31  
 N: 902300.0136  
 E: 1624923.0087

N: 902204.1359  
 E: 1625024.1167

EXISTING HAPPY CAMP  
 WC PARKING

MOTORCYCLE PARKING

CONTROL POINT #1  
 ELEV: 1250.84  
 N: 902079.9310  
 E: 1624995.6687

EXISTING FIBER OPTIC LINE

N: 902112.1293  
 E: 1625060.7273

EXISTING WATER LINE  
 (SIZE UNKNOWN)

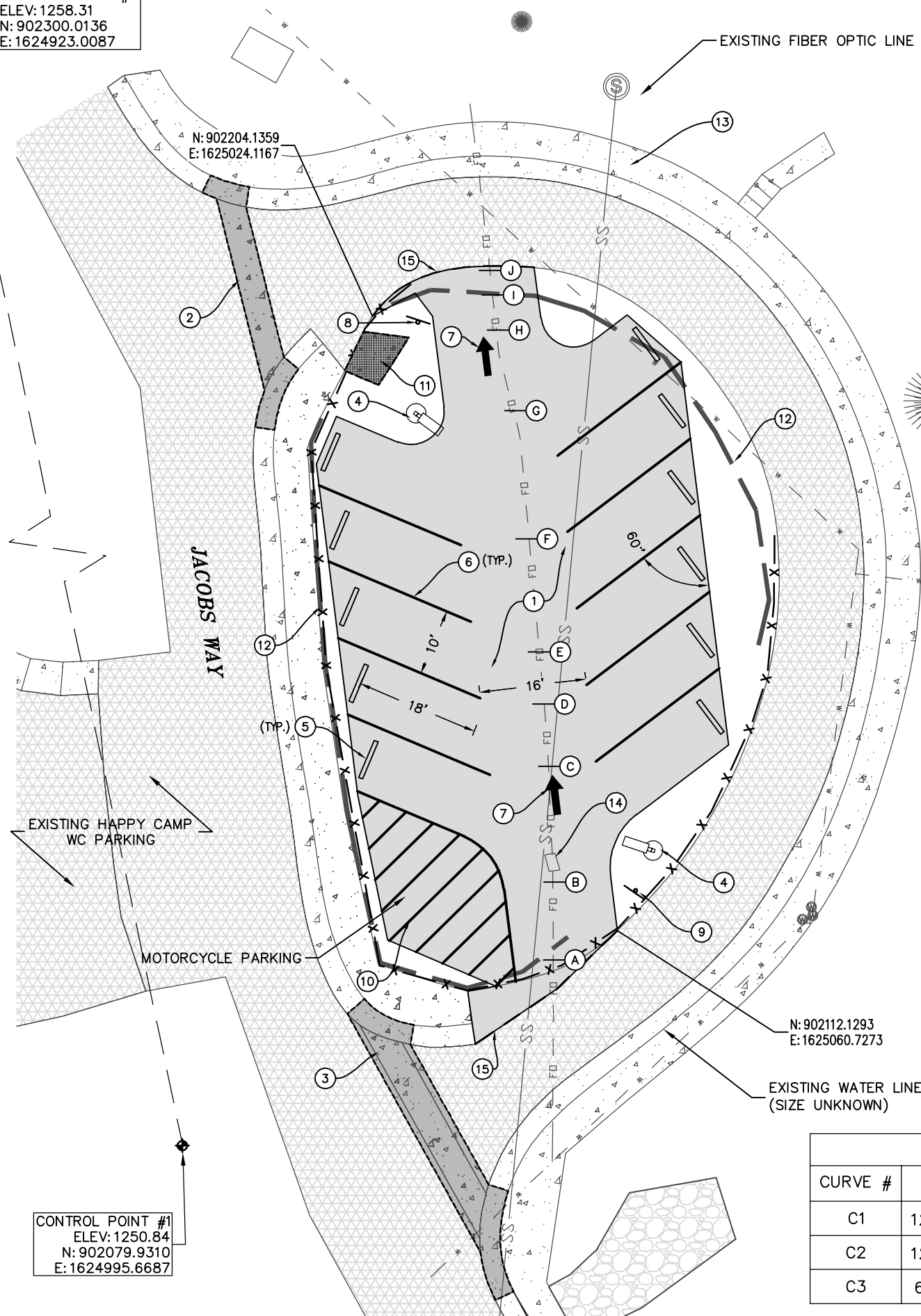
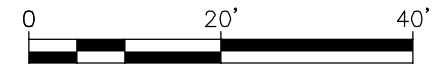

**CONSTRUCTION NOTES**

- ① CONSTRUCT HOT ASPHALT CONCRETE PAVEMENT (HACP) PER DETAIL SHEET 8
- ② SAWCUT EXISTING PAVEMENT AND CONSTRUCT 4' WIDE CONCRETE VALLEY GUTTER PER DETAIL SHEET 8
- ③ SAWCUT EXISTING PAVEMENT AND REMOVE EXISTING VALLEY GUTTER. CONSTRUCT 6' WIDE CONCRETE VALLEY GUTTER PER DETAIL SHEET 8
- ④ INSTALL BRIGHTA 290D SOLAR LIGHT ASSEMBLY AND STANDARD, OR APPROVED EQUIVALENT
- ⑤ INSTALL CONCRETE WHEEL STOP PER DETAIL SHEET 8
- ⑥ PAINT PARKING STALL STRIPE, 4" WIDE WHITE
- ⑦ TRAFFIC ARROW MARKING PER SHEET 8
- ⑧ INSTALL "DO NOT ENTER" SIGN (R5-1) W/ STEEL POST
- ⑨ INSTALL "ONE WAY" SIGN W/ STEEL POST
- ⑩ DIAGONAL STRIP, 4" WIDE AT 2' O.C., WHITE
- ⑪ SAWCUT AND REMOVE EXISTING CONCRETE
- ⑫ EXISTING WOOD RETAINING WALL TO BE REMOVED PRIOR TO CONSTRUCTION. CONTRACTOR TO COORDINATE WITH TRIBE
- ⑬ RELOCATE EXISTING F.O. LINE & JUNCTION BOX PER SERVICE PROVIDER'S STANDARDS AND REQUIREMENTS (SEE NOTE 1)
- ⑭ UTILITY VAULT TO BE RELOCATED BY OTHERS PRIOR TO CONSTRUCTION
- ⑮ SAWCUT EXISTING PAVEMENT

- PROPOSED ASPHALT
- PROPOSED CONCRETE
- EXISTING CONCRETE TO PROTECT IN PLACE
- EXISTING CONCRETE TO BE REMOVED
- EXISTING ASPHALT TO REMAIN

**NOTE 1**

APPROXIMATE FIBER OPTIC LOCATIONS & DEPTHS  
 BASED ON FIELD MEASUREMENTS

LOCATION	DEPTH FROM EXIST. GROUND	DEPTH FROM FINISH GRADE
A	2.3'	2.1'
B	3.5'	2.3'
C	1.1'	(0.6')
D	2.7'	0.7'
E	5.0'	2.9'
F	5.3'	3.0'
G	4.3'	2.4'
H	3.8'	2.3'
I	5.8'	3.5'
J	3.3'	3.3'

CURVE TABLE				
CURVE #	Δ	T	L	R
C1	120°00'00"	8.66'	10.47'	5.00'
C2	120°00'00"	8.66'	10.47'	5.00'
C3	60°00'00"	5.77'	10.47'	10.00'

**JACOBS WAY WCPPL**  
 KARUK TRIBE  
 HAPPY CAMP, CA  
**CONSTRUCTION PLAN**



RED PLAINS PROFESSIONAL, INC.  
 2103 NE 129TH STREET  
 SUITE 201  
 VANCOUVER, WA. 98686  
 TEL: (360) 448-7999  
 FAX: (360) 258-0274  
 www.red-plains.com

NO.	DATE	REVISIONS DESCRIPTION

Z:\PROJECTS\70006 - KARUK - T011 HAPPY CAMP WCPFL\16 CADD\PRODUCTION\HC\_SITE.DWG 6/29/2020 5:19:20 PM by:kevin.ortega

CONTROL POINT #2  
 ELEV: 1258.31  
 N: 902300.0136  
 E: 1624923.0087

CONTROL POINT #1  
 ELEV: 1250.84  
 N: 902079.9310  
 E: 1624995.6687

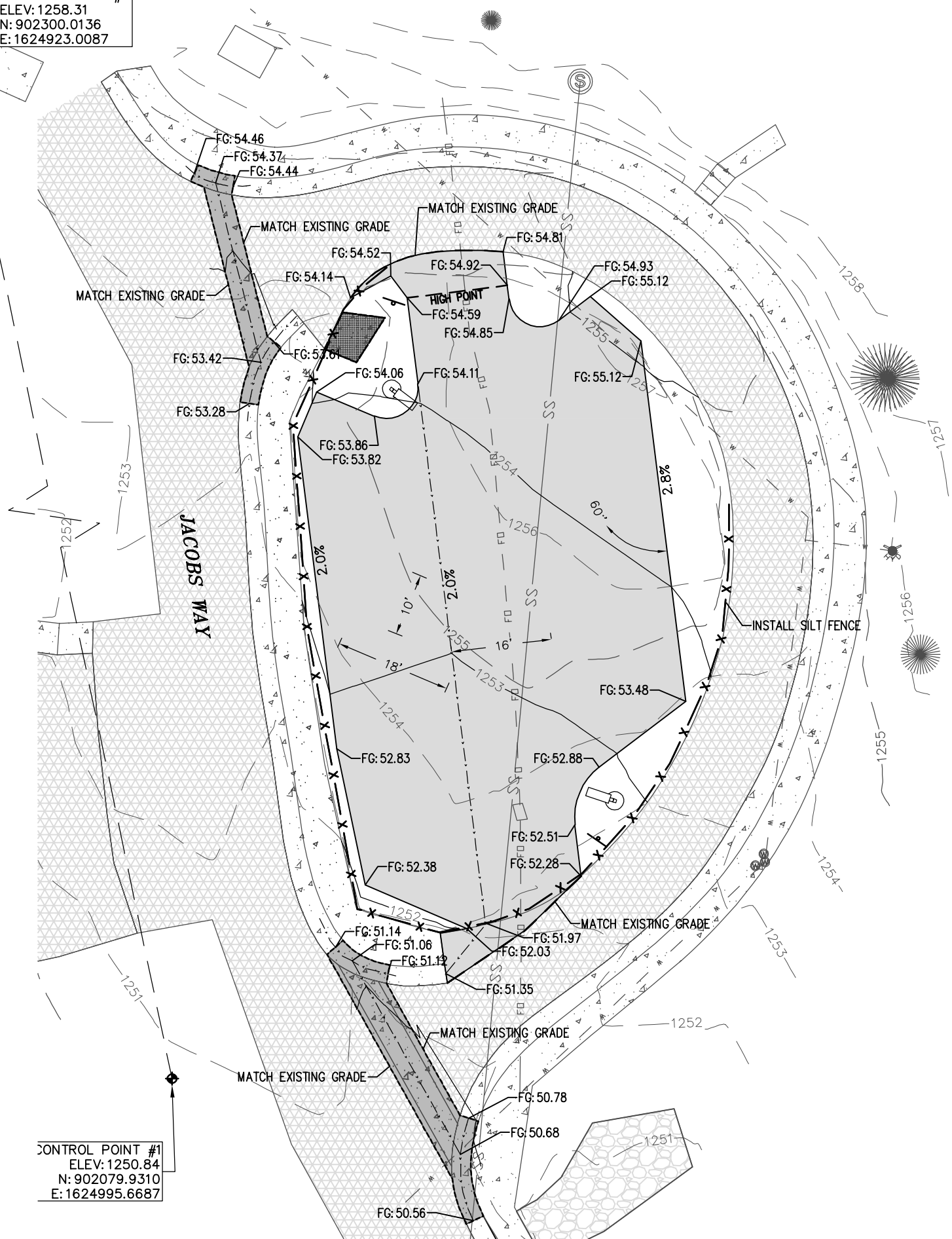

- PROPOSED ASPHALT
- PROPOSED CONCRETE
- EXISTING CONCRETE TO PROTECT IN PLACE
- EXISTING CONCRETE TO BE REMOVED
- EXISTING ASPHALT TO REMAIN

EARTHWORKS			
SITE	EXC. (CY)	EMB. (CY)	NET (CY)
PARKING LOT	155	15	140 EXCESS

**JACOBS WAY WCPL**  
 KARUK TRIBE  
 HAPPY CAMP, CA  
**GRADING PLAN**



RED PLAINS PROFESSIONAL, INC.  
 2103 NE 129TH STREET  
 SUITE 201  
 VANCOUVER, WA. 98686  
 TEL: (360) 448-7999  
 FAX: (360) 258-0274  
 www.red-plains.com

NO.	DATE	REVISIONS DESCRIPTION

Z:\PROJECTS\70006 - KARUK - T011 HAPPY CAMP WCP\16 CADD\PRODUCTION\HC\_DETAILS.DWG 6/29/2020 5:19:40 PM by:kevin.ortega

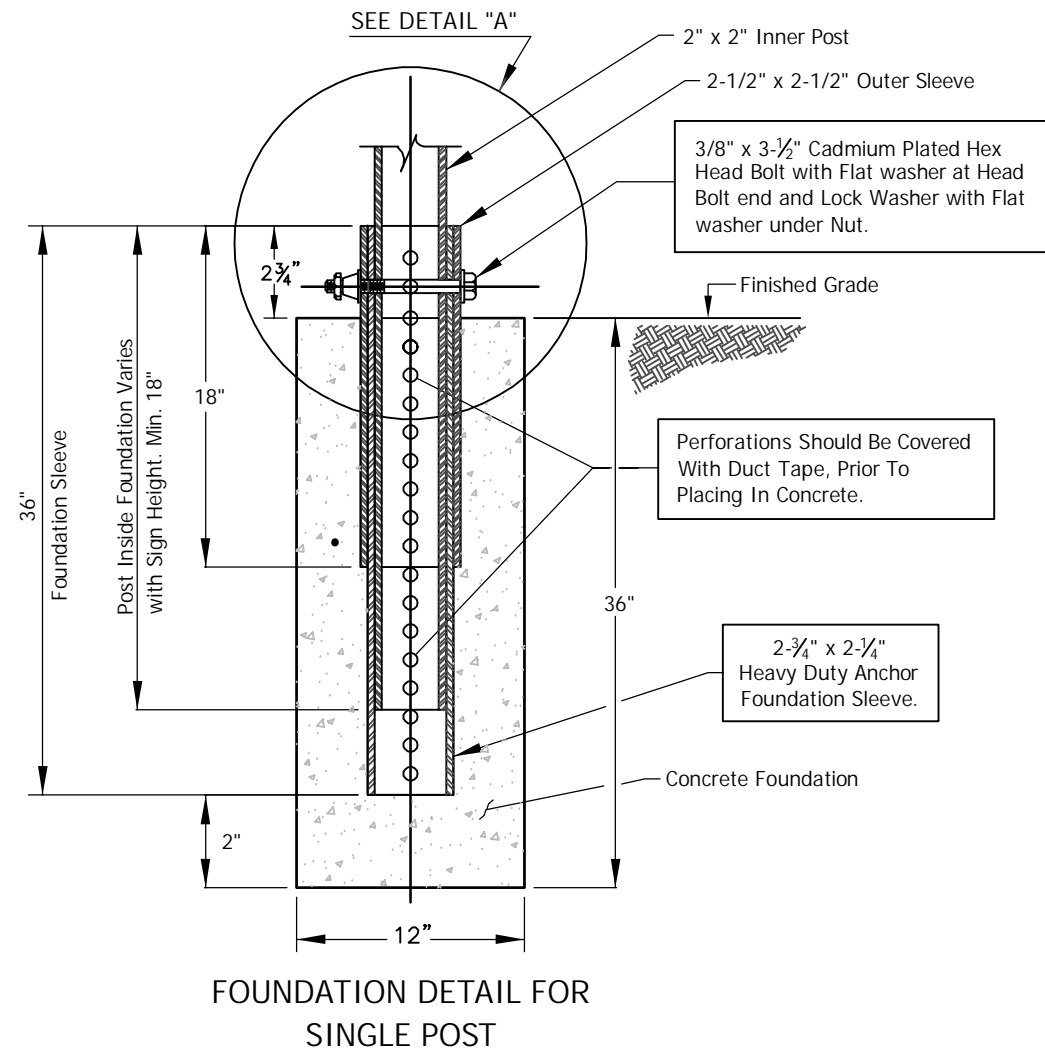

FOUNDATION DETAIL FOR SINGLE POST

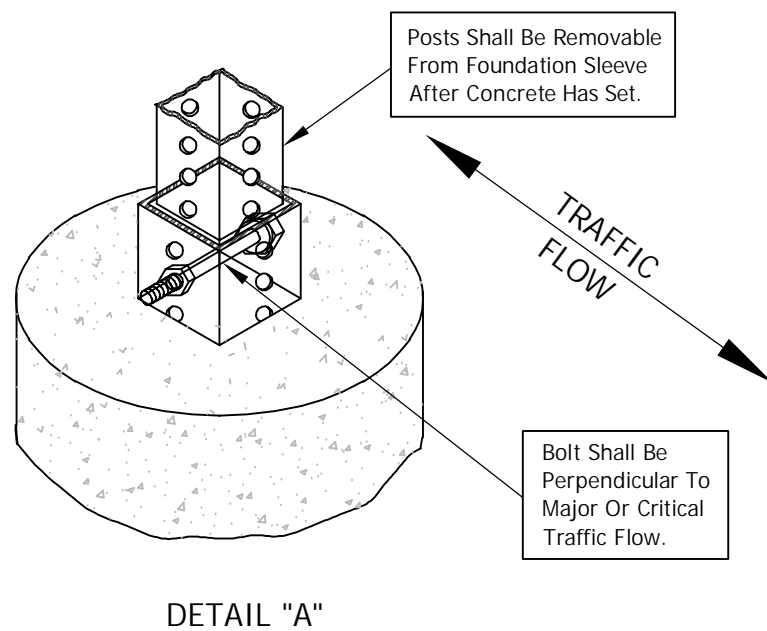

DETAIL "A"

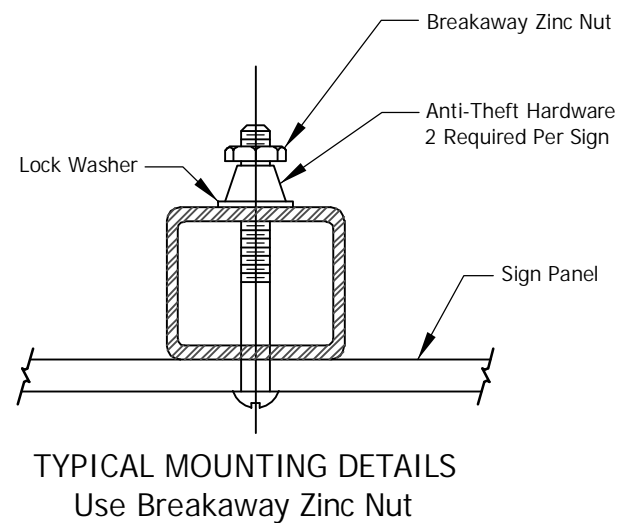

GENERAL NOTES

1. If any Post section is shorter than the Panel Height, the Field Splice Shall be behind the Panel.
2. Field Splices are Not Permitted on Telescoping Posts.
3. Provide Vandal Proof Sign Hardware.

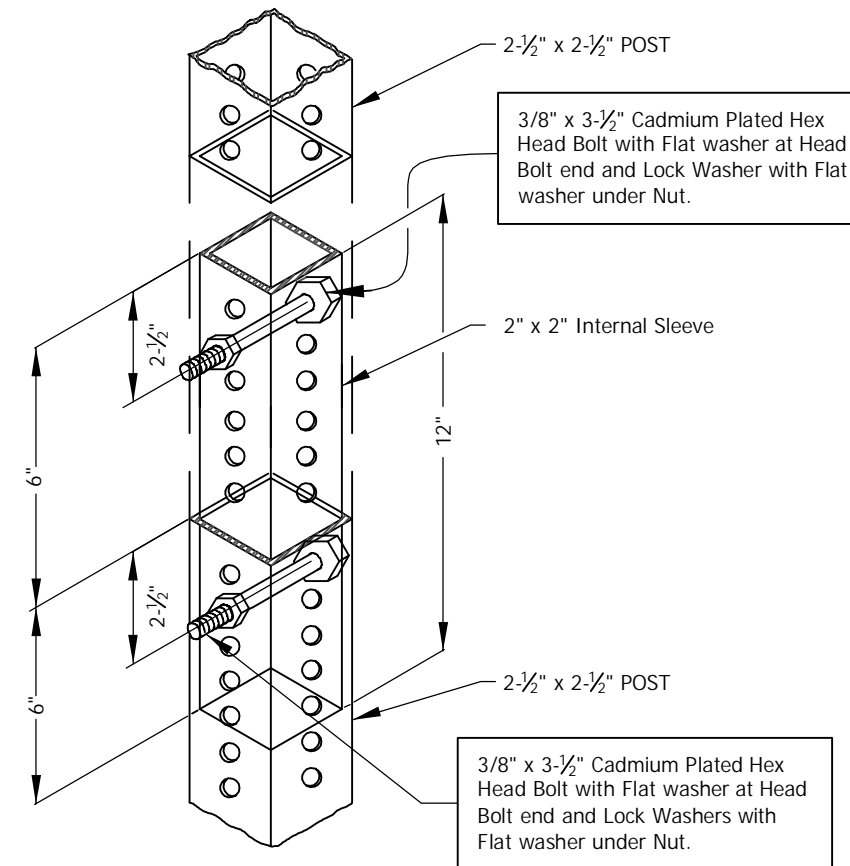

PERMISSIBLE FIELD SPLICE PERFORATED POST DETAIL

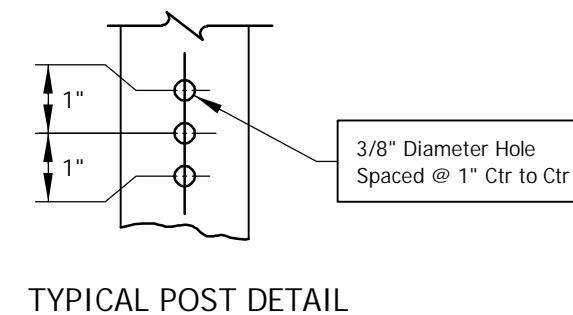

JACOBS WAY WCP  
KARUK TRIBE  
JACOBS WAY, HAPPY CAMP, CA  
SIGN POST DETAILS



RED PLAINS PROFESSIONAL, INC.  
2103 NE 129TH STREET  
SUITE 201  
VANCOUVER, WA. 98686  
TEL: (360) 448-7999  
FAX: (360) 258-0274  
www.red-plains.com

NO.	DATE	REVISIONS	DESCRIPTION

Z:\PROJECTS\70006 - KARUK - T011 HAPPY CAMP WCPF\16 CADD\PRODUCTION\HC\_DETAILS.DWG 6/29/2020 5:19:44 PM by:kevin.ortega

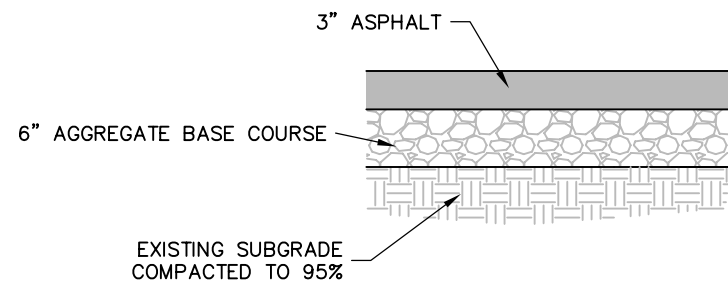

**TYPICAL PAVEMENT SECTION**  
NOT TO SCALE

A (ft.)	B (ft.)	C (in.)
4	1.33	1
6	2	1 1/2

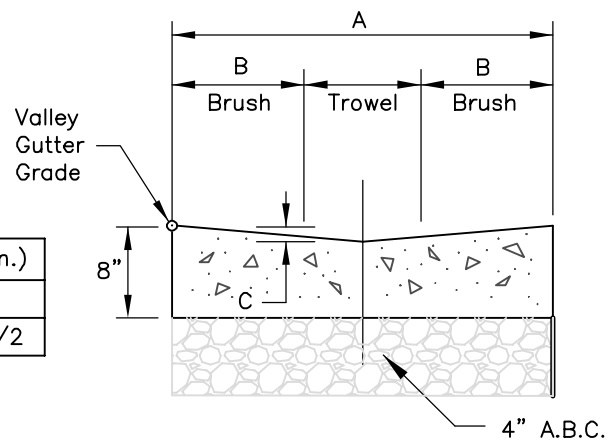

**CONCRETE VALLEY GUTTER**  
NOT TO SCALE

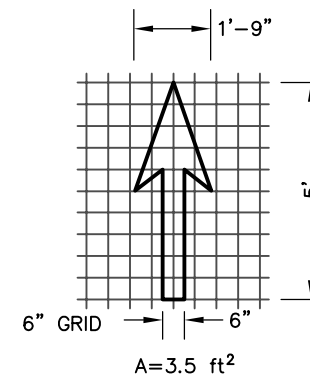

**DIRECTIONAL ARROWS**  
NOT TO SCALE

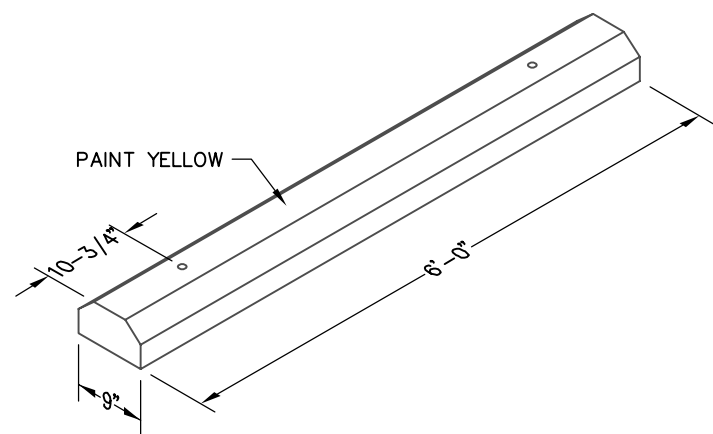

**PRECAST CONCRETE WHEEL STOP**  
NOT TO SCALE

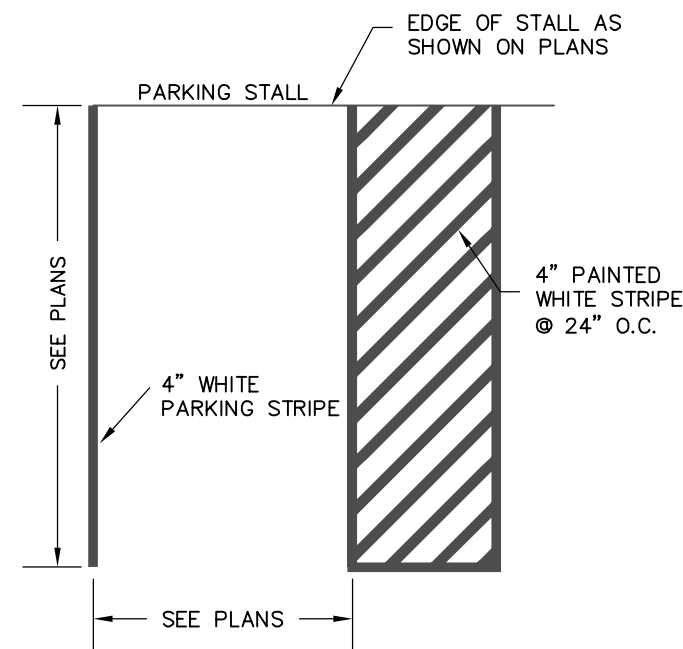
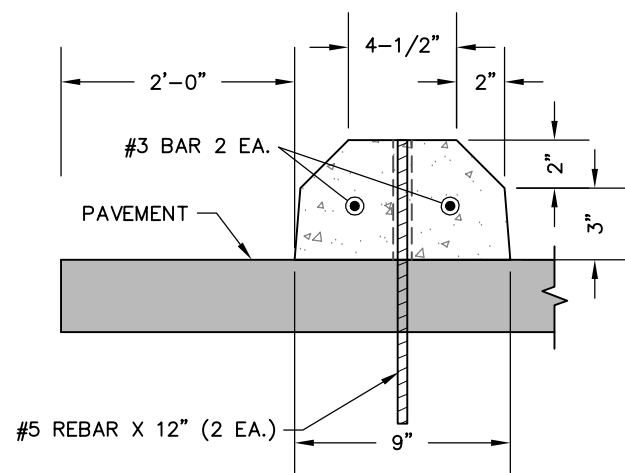

**PARKING STALL DETAIL**  
NOT TO SCALE

**JACOBS WAY WCPL**  
KARUK TRIBE  
JACOBS WAY, HAPPY CAMP, CA  
**MISC. DETAILS**

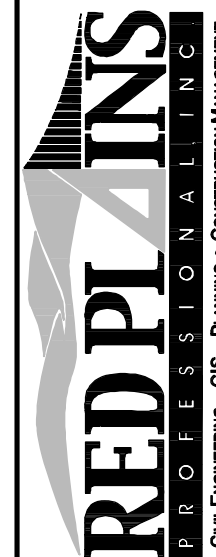

RED PLAINS PROFESSIONAL, INC.  
2103 NE 129TH STREET  
SUITE 201  
VANCOUVER, WA. 98686  
TEL: (360) 448-7999  
FAX: (360) 258-0274  
www.red-plains.com

NO.	DATE	REVISIONS DESCRIPTION