

APPENDIX A
USFWS Correspondence



United States Department of the Interior



FISH AND WILDLIFE SERVICE
Yreka Fish And Wildlife Office
1829 South Oregon Street
Yreka, CA 96097-3446
Phone: (530) 842-5763 Fax: (530) 842-4517

In Reply Refer To:

January 14, 2020

Consultation Code: 08EYRE00-2020-SLI-0044

Event Code: 08EYRE00-2020-E-00148

Project Name: Karuk Judicial Center

Subject: List of threatened and endangered species that may occur in your proposed project location, and/or may be affected by your proposed project

To Whom It May Concern:

The enclosed species list identifies federally threatened, endangered, and proposed species, designated critical habitat, and candidate species that may occur within the boundary of your proposed project and/or may be affected by your proposed project. The species list fulfills the requirements of the U.S. Fish and Wildlife Service (Service) under section 7(c) of the Endangered Species Act (Act) of 1973, as amended (16 U.S.C. 1531 et seq.). Please note that this list does not reflect State listed species or fulfill requirements related to any California Department of Fish and Wildlife consultation. Additionally, this list does not include species covered by the National Marine Fisheries Service (NMFS). For NMFS species please see the related website at the following link:

http://www.nwr.noaa.gov/protected_species/species_list/species_lists.html

If your project does not involve Federal funding or permits and does not occur on Federal land, we recommend you review this list and determine if any of these species or critical habitat may be affected. If you determine that there will be no effects to federally listed or proposed species or critical habitat, there is no need to coordinate with the Service. If you think or know that there will be effects, please contact our office for further guidance. We can assist you in incorporating measures to avoid or minimize impacts, and discuss whether permits are needed.

New information based on updated surveys, changes in the abundance and distribution of species, changed habitat conditions, or other factors could change this list. Please feel free to contact us if you need more current information or assistance regarding the potential effects to federally proposed, listed, and candidate species and federally designated and proposed critical habitat. Please note that under 50 CFR 402.12(e) of the regulations implementing section 7 of the Act, the accuracy of this species list should be verified after 90 days. This verification can be completed formally or informally as desired. The Service recommends that verification be

completed by visiting the ECOS-IPaC website at regular intervals during project planning and implementation for updates to species lists and information. An updated list may be requested through the ECOS-IPaC system by completing the same process used to receive the enclosed list.

The purpose of the Act is to provide a means whereby threatened and endangered species and the ecosystems upon which they depend may be conserved. Under sections 7(a)(1) and 7(a)(2) of the Act and its implementing regulations (50 CFR 402 et seq.), Federal agencies are required to utilize their authorities to carry out programs for the conservation of threatened and endangered species and to determine whether projects may affect threatened and endangered species and/or designated critical habitat.

A Biological Assessment is required for construction projects (or other undertakings having similar physical impacts) that are major Federal actions significantly affecting the quality of the human environment as defined in the National Environmental Policy Act (42 U.S.C. 4332(2) (c)). For projects other than major construction activities, the Service suggests that a biological evaluation similar to a Biological Assessment be prepared to determine whether the project may affect listed or proposed species and/or designated or proposed critical habitat. Recommended contents of a Biological Assessment are described at 50 CFR 402.12.

If a Federal agency determines, based on the Biological Assessment or biological evaluation, that listed species and/or designated critical habitat may be affected by the proposed project, the agency is required to consult with the Service pursuant to 50 CFR 402. In addition, the Service recommends that candidate species, proposed species and proposed critical habitat be addressed within the consultation. More information on the regulations and procedures for section 7 consultation, including the role of permit or license applicants, can be found in the "Endangered Species Consultation Handbook" at:

<http://www.fws.gov/endangered/esa-library/pdf/TOC-GLOS.PDF>

If wetlands, springs, or streams are known to occur in the project area or are present in the vicinity of the project area, we ask that you be aware of potential impacts project activities may have on these habitats. Discharge of fill material into wetlands or waters of the United States is regulated by the U.S. Army Corps of Engineers (ACOE) pursuant to section 404 of the Clean Water Act of 1972, as amended. We recommend you contact the ACOE's Regulatory Section regarding the possible need for a permit.

Please be aware that bald and golden eagles are protected under the Bald and Golden Eagle Protection Act (16 U.S.C. 668 et seq.), and projects affecting these species may require development of an eagle conservation plan (http://www.fws.gov/windenergy/eagle_guidance.html).

Additionally, wind energy projects should follow the wind energy guidelines (<http://www.fws.gov/windenergy/>) for minimizing impacts to migratory birds and bats.

Guidance for minimizing impacts to migratory birds for projects including communications towers (e.g., cellular, digital television, radio, and emergency broadcast) can be found at: <http://>

www.fws.gov/migratorybirds/CurrentBirdIssues/Hazards/towers/towers.htm; <http://www.towerkill.com>; and <http://www.fws.gov/migratorybirds/CurrentBirdIssues/Hazards/towers/comtow.html>.

The table below outlines lead Service field offices by county and land ownership/project type. Please refer to this table when you are ready to coordinate (including requests for section 7 consultation) with the field office corresponding to your project. Please send any documentation regarding your project to that office. Please note that the lead Service field office for your consultation may not be the office listed above in the letterhead. Please visit the following link to view a map of Service field office jurisdictional boundaries:

http://www.fws.gov/yreka/specieslist/JurisdictionalBoundaryES_R8_20150313.pdf

We appreciate your concern for threatened and endangered species. Please include the Consultation Tracking Number in the header of the letter you submit to our office along with any request for consultation or correspondence about your project.

Lead FWS offices by County and Ownership/Program

County	Ownership/Program	Species	Office Lead*
Alameda	Tidal wetlands/marsh adjacent to Bays	Salt marsh species, delta smelt	BDFWO
Alameda	All ownerships but tidal/estuarine	All	SFWO
Alpine	Humboldt Toiyabe National Forest	All	RFWO
Alpine	Lake Tahoe Basin Management Unit	All	RFWO
Alpine	Stanislaus National Forest	All	SFWO
Alpine	El Dorado National Forest	All	SFWO
Colusa	Mendocino National Forest	All	AFWO
Colusa	Other	All	By jurisdiction (see map)
Contra Costa	Legal Delta (Excluding ECCHCP)	All	BDFWO
Contra Costa	Antioch Dunes NWR	All	BDFWO

Contra Costa	Tidal wetlands/marsh adjacent to Bays	Salt marsh species, delta smelt	BDFWO
Contra Costa	All ownerships but tidal/estuarine	All	SFWO
Del Norte	All	All	AFWO
El Dorado	El Dorado National Forest	All	SFWO
El Dorado	LakeTahoe Basin Management Unit		RFWO
Glenn	Mendocino National Forest	All	AFWO
Glenn	Other	All	By jurisdiction (see map)
Humboldt	All except Shasta Trinity National Forest	All	AFWO
Humboldt	Shasta Trinity National Forest	All	YFWO
Lake	Mendocino National Forest	All	AFWO
Lake	Other	All	By jurisdiction (see map)
Lassen	Modoc National Forest	All	KFWO
Lassen	Lassen National Forest	All	SFWO
Lassen	Toiyabe National Forest	All	RFWO
Lassen	BLM Surprise and Eagle Lake Resource Areas	All	RFWO
Lassen	BLM Alturas Resource Area	All	KFWO
Lassen	Lassen Volcanic National Park	All (includes Eagle Lake trout on all ownerships)	SFWO
Lassen	All other ownerships	All	By jurisdiction (see map)

Marin	Tidal wetlands/marsh adjacent to Bays	Salt marsh species, delta smelt	BDFWO
Marin	All ownerships but tidal/estuarine	All	SFWO
Mendocino	Russian River watershed	All	SFWO
Mendocino	All except Russian River watershed	All	AFWO
Modoc	Modoc National Forest	All	KFWO
Modoc	BLM Alturas Resource Area	All	KFWO
Modoc	Klamath Basin National Wildlife Refuge Complex	All	KFWO
Modoc	BLM Surprise and Eagle Lake Resource Areas	All	RFWO
Modoc	All other ownerships	All	By jurisdiction (See map)
Mono	Inyo National Forest	All	RFWO
Mono	Humboldt Toiyabe National Forest	All	RFWO
Napa	All ownerships but tidal/estuarine	All	SFWO
Napa	Tidal wetlands/marsh adjacent to San Pablo Bay	Salt marsh species, delta smelt	BDFWO
Nevada	Humboldt Toiyabe National Forest	All	RFWO
Nevada	All other ownerships	All	By jurisdiction (See map)
Placer	Lake Tahoe Basin Management Unit	All	RFWO
Placer	All other ownerships	All	SFWO

Sacramento	Legal Delta	Delta Smelt	BDFWO
Sacramento	Other	All	By jurisdiction (see map)
San Francisco	Tidal wetlands/marsh adjacent to San Francisco Bay	Salt marsh species, delta smelt	BDFWO
San Francisco	All ownerships but tidal/estuarine	All	SFWO
San Mateo	Tidal wetlands/marsh adjacent to San Francisco Bay	Salt marsh species, delta smelt	BDFWO
San Mateo	All ownerships but tidal/estuarine	All	SFWO
San Joaquin	Legal Delta excluding San Joaquin HCP	All	BDFWO
San Joaquin	Other	All	SFWO
Santa Clara	Tidal wetlands/marsh adjacent to San Francisco Bay	Salt marsh species, delta smelt	BDFWO
Santa Clara	All ownerships but tidal/estuarine	All	SFWO
Shasta	Shasta Trinity National Forest except Hat Creek Ranger District (administered by Lassen National Forest)	All	YFWO
Shasta	Hat Creek Ranger District	All	SFWO
Shasta	Bureau of Reclamation (Central Valley Project)	All	BDFWO
Shasta	Whiskeytown National Recreation Area	All	YFWO
Shasta	BLM Alturas Resource Area	All	KFWO
Shasta	Caltrans	By jurisdiction	SFWO/AFWO

Shasta	Ahjumawi Lava Springs State Park	Shasta crayfish	SFWO
Shasta	All other ownerships	All	By jurisdiction (see map)
Shasta	Natural Resource Damage Assessment, all lands	All	SFWO/BDFWO
Sierra	Humboldt Toiyabe National Forest	All	RFWO
Sierra	All other ownerships	All	SFWO
Siskiyou	Klamath National Forest (except Ukonom District)	All	YFWO
Siskiyou	Six Rivers National Forest and Ukonom District	All	AFWO
Siskiyou	Shasta Trinity National Forest	All	YFWO
Siskiyou	Lassen National Forest	All	SFWO
Siskiyou	Modoc National Forest	All	KFWO
Siskiyou	Lava Beds National Volcanic Monument	All	KFWO
Siskiyou	BLM Alturas Resource Area	All	KFWO
Siskiyou	Klamath Basin National Wildlife Refuge Complex	All	KFWO
Siskiyou	All other ownerships	All	By jurisdiction (see map)
Solano	Suisun Marsh	All	BDFWO
Solano	Tidal wetlands/marsh adjacent to San Pablo Bay	Salt marsh species, delta smelt	BDFWO
Solano	All ownerships but tidal/estuarine	All	SFWO
Solano	Other	All	By jurisdiction (see map)

Sonoma	Tidal wetlands/marsh adjacent to San Pablo Bay	Salt marsh species, delta smelt	BDFWO
Sonoma	All ownerships but tidal/estuarine	All	SFWO
Tehama	Mendocino National Forest	All	AFWO
Tehama	Shasta Trinity National Forest except Hat Creek Ranger District (administered by Lassen National Forest)	All	YFWO
Tehama	All other ownerships	All	By jurisdiction (see map)
Trinity	BLM	All	AFWO
Trinity	Six Rivers National Forest	All	AFWO
Trinity	Shasta Trinity National Forest	All	YFWO
Trinity	Mendocino National Forest	All	AFWO
Trinity	BIA (Tribal Trust Lands)	All	AFWO
Trinity	County Government	All	AFWO
Trinity	All other ownerships	All	By jurisdiction (See map)
Yolo	Yolo Bypass	All	BDFWO
Yolo	Other	All	By jurisdiction (see map)
All	FERC-ESA	All	By jurisdiction (see map)
All	FERC-ESA	Shasta crayfish	SFWO
All	FERC-Relicensing (non-ESA)	All	BDFWO

***Office Leads:**

AFWO=Arcata Fish and Wildlife Office

BDFWO=Bay Delta Fish and Wildlife Office

KFWO=Klamath Falls Fish and Wildlife Office

RFWO=Reno Fish and Wildlife Office

YFWO=Yreka Fish and Wildlife Office

Attachment(s):

- Official Species List

Official Species List

This list is provided pursuant to Section 7 of the Endangered Species Act, and fulfills the requirement for Federal agencies to "request of the Secretary of the Interior information whether any species which is listed or proposed to be listed may be present in the area of a proposed action".

This species list is provided by:

Yreka Fish And Wildlife Office

1829 South Oregon Street

Yreka, CA 96097-3446

(530) 842-5763

Project Summary

Consultation Code: 08EYRE00-2020-SLI-0044

Event Code: 08EYRE00-2020-E-00148

Project Name: Karuk Judicial Center

Project Type: Federal Grant / Loan Related

Project Description: Construction of a 2,400 square foot modular building that will house a tribal court

Project Location:

Approximate location of the project can be viewed in Google Maps: <https://www.google.com/maps/place/41.71411027151281N122.6281277622484W>

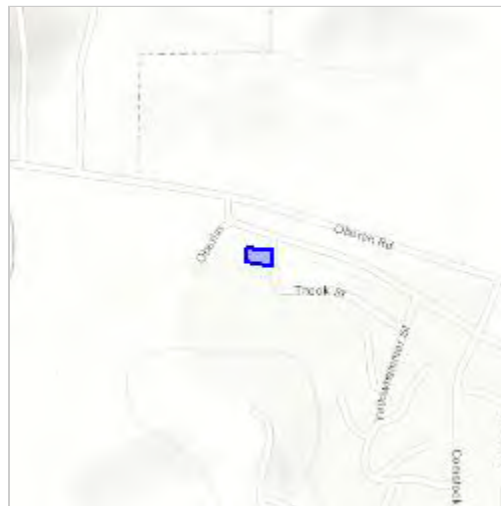

Counties: Siskiyou, CA

Endangered Species Act Species

There is a total of 13 threatened, endangered, or candidate species on this species list.

Species on this list should be considered in an effects analysis for your project and could include species that exist in another geographic area. For example, certain fish may appear on the species list because a project could affect downstream species.

IPaC does not display listed species or critical habitats under the sole jurisdiction of NOAA Fisheries¹, as USFWS does not have the authority to speak on behalf of NOAA and the Department of Commerce.

See the "Critical habitats" section below for those critical habitats that lie wholly or partially within your project area under this office's jurisdiction. Please contact the designated FWS office if you have questions.

-
1. [NOAA Fisheries](#), also known as the National Marine Fisheries Service (NMFS), is an office of the National Oceanic and Atmospheric Administration within the Department of Commerce.

Mammals

NAME	STATUS
Fisher <i>Pekania pennanti</i> Population: West coast DPS No critical habitat has been designated for this species. Species profile: https://ecos.fws.gov/ecp/species/3651	Proposed Threatened
Gray Wolf <i>Canis lupus</i> Population: U.S.A.: All of AL, AR, CA, CO, CT, DE, FL, GA, IA, IN, IL, KS, KY, LA, MA, MD, ME, MI, MO, MS, NC, ND, NE, NH, NJ, NV, NY, OH, OK, PA, RI, SC, SD, TN, TX, VA, VT, WI, and WV; and portions of AZ, NM, OR, UT, and WA. Mexico. There is final critical habitat for this species. The location of the critical habitat is not available. Species profile: https://ecos.fws.gov/ecp/species/4488	Endangered
North American Wolverine <i>Gulo gulo luscus</i> No critical habitat has been designated for this species. Species profile: https://ecos.fws.gov/ecp/species/5123	Proposed Threatened

Birds

NAME	STATUS
Northern Spotted Owl <i>Strix occidentalis caurina</i> There is final critical habitat for this species. Your location is outside the critical habitat. Species profile: https://ecos.fws.gov/ecp/species/1123	Threatened
Yellow-billed Cuckoo <i>Coccyzus americanus</i> Population: Western U.S. DPS There is proposed critical habitat for this species. Your location is outside the critical habitat. Species profile: https://ecos.fws.gov/ecp/species/3911	Threatened

Amphibians

NAME	STATUS
Oregon Spotted Frog <i>Rana pretiosa</i> There is final critical habitat for this species. Your location is outside the critical habitat. Species profile: https://ecos.fws.gov/ecp/species/6633	Threatened

Fishes

NAME	STATUS
Lost River Sucker <i>Deltistes luxatus</i> There is final critical habitat for this species. Your location is outside the critical habitat. Species profile: https://ecos.fws.gov/ecp/species/5604	Endangered
Shortnose Sucker <i>Chasmistes brevirostris</i> There is final critical habitat for this species. Your location is outside the critical habitat. Species profile: https://ecos.fws.gov/ecp/species/7160	Endangered

Crustaceans

NAME	STATUS
Conservancy Fairy Shrimp <i>Branchinecta conservatio</i> There is final critical habitat for this species. Your location is outside the critical habitat. Species profile: https://ecos.fws.gov/ecp/species/8246	Endangered
Vernal Pool Fairy Shrimp <i>Branchinecta lynchi</i> There is final critical habitat for this species. Your location is outside the critical habitat. Species profile: https://ecos.fws.gov/ecp/species/498	Threatened
Vernal Pool Tadpole Shrimp <i>Lepidurus packardii</i> There is final critical habitat for this species. Your location is outside the critical habitat. Species profile: https://ecos.fws.gov/ecp/species/2246	Endangered

Flowering Plants

NAME	STATUS
Gentner's Fritillary <i>Fritillaria gentneri</i> No critical habitat has been designated for this species. Species profile: https://ecos.fws.gov/ecp/species/8120	Endangered
Yreka Phlox <i>Phlox hirsuta</i> No critical habitat has been designated for this species. Species profile: https://ecos.fws.gov/ecp/species/8243	Endangered

Critical habitats

THERE ARE NO CRITICAL HABITATS WITHIN YOUR PROJECT AREA UNDER THIS OFFICE'S JURISDICTION.

APPENDIX B
THPO Correspondence



February 14, 2020

7329.18

Karuk Tribe
Department of Natural Resources
P.O. Box 282
Orleans, California 95556

Attention: Dr. Alex Tobin, Archaeologist, THPO

Subject: Construction of the Karuk Judicial Center, 1221 Thook Street, Yreka, CA 96097- APN# 062-061-030

Dear Mr. Tobin:

LACO Associates (LACO) has been engaged by the Karuk Tribe to conduct an environmental assessment pursuant to the National Environmental Policy Act of 1969 (NEPA) (40 CFR § 1500-1508) to assist the U.S. Department of Justice (DOJ) to comply with 42 U.S.C. § 4371 et. seq., all applicable federal regulations and Office of Justice Programs for the proposed construction of a modular Judicial Center and associated improvements on Tribal trust property located in Yreka, California.

Pursuant to the National Historic Preservation Act (P.L. 89-665), Preservation of Historic and Archaeological Data Act (P.L. 93-291), Executive Order 11593, and Protection and Enhancement of the Cultural Environment (36 CFR Part 800 or 801 as amended) agencies are to identify and take into account the adverse effect their proposed project may have on the historic and prehistoric resources in the Area of Potential Effect (APE).

The 25.59-acre parcel (APN# 062-061-030) with a 0.34-acre portion to be developed for the Karuk Judicial Center is located in a portion of Section 26, Township 45 North, Range 7 West of the Mount Diablo Meridian, Siskiyou County, California. The project site, which is largely vacant and undeveloped, is part of the Karuk Tribe's trust lands, located off of Thook Road. The proposed undertaking with the Area of Potential Effect delineated is located within the Yreka Quadrangle and is depicted on the attached topographic map and project location map.

By being aligned with the other tribal and non-tribal social service, health, and administrative entities, the Justice Center is a proposed 2,800 square foot modular facility that will house the Tribal Court and wellness center.

Dr. Alex Tobin, Archaeologist, THPO

January 28, 2020

Page Two

Based on the historical disturbance of the property, it is our opinion that the construction of the Karuk Justice Center will not likely affect historical and cultural resources. The installation of the modular building will entail footings, water line and sewer line installations and very minor disturbance areas, Respectfully, we are recommending having Karuk Tribal monitors in place during these minor earthmoving activities.

After consultation with your office and the Karuk Resources Advisory Board, the Tribe will proceed with plans for the Judicial Center.

Respectfully, we are requesting the Karuk Resources Advisory Board and your concurrence that the proposed project will likely have no adverse effect on archeological or historic resources at the subject parcel if Tribal monitors are present to observe.

We would appreciate a response as quickly as possible.

Sincerely,

LACO Associates

A handwritten signature in black ink, reading "L. Robert Ulibarri". The signature is written in a cursive style with a long, sweeping underline that extends to the right.

L. Robert Ulibarri, AICP/REA
Senior Environmental Planner
Tribal Government Services Manager



APPENDIX C
FIRM Panel Map

National Flood Hazard Layer FIRMette



Legend

SEE FIS REPORT FOR DETAILED LEGEND AND INDEX MAP FOR FIRM PANEL LAYOUT

SPECIAL FLOOD HAZARD AREAS		Without Base Flood Elevation (BFE) Zone A, V, A99
		With BFE or Depth Zone AE, AO, AH, VE, AR
		Regulatory Floodway

OTHER AREAS OF FLOOD HAZARD		0.2% Annual Chance Flood Hazard, Areas of 1% annual chance flood with average depth less than one foot or with drainage areas of less than one square mile Zone X
		Future Conditions 1% Annual Chance Flood Hazard Zone X
		Area with Reduced Flood Risk due to Levee. See Notes. Zone X
		Area with Flood Risk due to Levee Zone D

OTHER AREAS		Area of Minimal Flood Hazard Zone X
		Effective LOMRs
		Area of Undetermined Flood Hazard Zone D

GENERAL STRUCTURES		Channel, Culvert, or Storm Sewer
		Levee, Dike, or Floodwall

OTHER FEATURES		Cross Sections with 1% Annual Chance Water Surface Elevation
		Coastal Transect
		Base Flood Elevation Line (BFE)
		Limit of Study
		Jurisdiction Boundary
		Coastal Transect Baseline
		Profile Baseline
		Hydrographic Feature

MAP PANELS		Digital Data Available
		No Digital Data Available
		Unmapped

The pin displayed on the map is an approximate point selected by the user and does not represent an authoritative property location.

This map complies with FEMA's standards for the use of digital flood maps if it is not void as described below. The basemap shown complies with FEMA's basemap accuracy standards

The flood hazard information is derived directly from the authoritative NFHL web services provided by FEMA. This map was exported on 1/15/2020 at 11:26:48 AM and does not reflect changes or amendments subsequent to this date and time. The NFHL and effective information may change or become superseded by new data over time.

This map image is void if the one or more of the following map elements do not appear: basemap imagery, flood zone labels, legend, scale bar, map creation date, community identifiers, FIRM panel number, and FIRM effective date. Map images for unmapped and unmodernized areas cannot be used for regulatory purposes.

122°37'59.11"W

41°43'3.15"N



122°37'21.65"W

USGS The National Map: Orthoimagery. Data refreshed April, 2019.

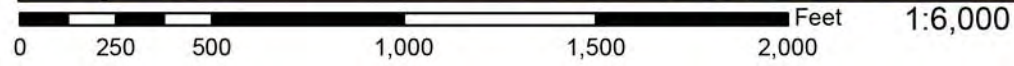

41°42'36.30"N

APPENDIX D
National Wetlands Inventory



U.S. Fish and Wildlife Service, National Standards and Support Team, wetlands_team@fws.gov

January 15, 2020

Wetlands

- | | | |
|--------------------------------|-----------------------------------|----------|
| Estuarine and Marine Deepwater | Freshwater Emergent Wetland | Lake |
| Estuarine and Marine Wetland | Freshwater Forested/Shrub Wetland | Other |
| | Freshwater Pond | Riverine |

This map is for general reference only. The US Fish and Wildlife Service is not responsible for the accuracy or currentness of the base data shown on this map. All wetlands related data should be used in accordance with the layer metadata found on the Wetlands Mapper web site.

APPENDIX E
CalEEMod Model Results

Karuk Judicial Center - Siskiyou County, Annual

**Karuk Judicial Center
Siskiyou County, Annual**

1.0 Project Characteristics

1.1 Land Usage

Land Uses	Size	Metric	Lot Acreage	Floor Surface Area	Population
Government Office Building	2.80	1000sqft	0.06	2,800.00	0
Parking Lot	12.00	Space	0.11	4,800.00	0

1.2 Other Project Characteristics

Urbanization	Urban	Wind Speed (m/s)	2.2	Precipitation Freq (Days)	85
Climate Zone	14			Operational Year	2021
Utility Company	PacifiCorp				
CO2 Intensity (lb/MW hr)	1656.39	CH4 Intensity (lb/MW hr)	0.029	N2O Intensity (lb/MW hr)	0.006

1.3 User Entered Comments & Non-Default Data

Project Characteristics -

Land Use - The proposed project involves placement of a 2,800-square-foot modular facility to house the Tribal Court and wellness center, in addition to construction of a small parking lot containing 12 spaces total (10 standard and 2 ADA spaces).

Construction Phase - No demolition is required, as the site is currently vacant.

Off-road Equipment - No demolition required for project.

Off-road Equipment - Default assumptions.

Off-road Equipment - Default assumptions.

Off-road Equipment - Default assumptions.

Off-road Equipment - Default assumptions.

Karuk Judicial Center - Siskiyou County, Annual

Off-road Equipment - Default assumptions.
Grading - Default assumptions.

Demolition - No demolition required for project.

Trips and VMT - Default assumptions. No demolition required for project.

On-road Fugitive Dust - Default assumptions.

Architectural Coating - Default assumptions.

Vehicle Trips - Default assumptions.

Vehicle Emission Factors - Default assumptions.

Vehicle Emission Factors - Default assumptions.

Vehicle Emission Factors - Default assumptions.

Road Dust - Default assumptions. Assumes vehicle speed would be reduced to 10 mph on unpaved roads.

Consumer Products - Default assumptions.

Area Coating - Default assumptions.

Landscape Equipment - Default assumptions.

Energy Use - Default assumptions.

Water And Wastewater - Default assumptions.

Solid Waste - Default assumptions.

Construction Off-road Equipment Mitigation - Assumes unpaved areas would be watered twice per day and vehicle speeds on unpaved roads would be reduced to 10mph.

Area Mitigation - Assumes use of low-VOC paints and cleaning supplies.

Energy Mitigation - Assumes use of high efficiency lighting.

Water Mitigation - Assumes installation of low-flow fixtures and use of water-efficient landscape and irrigation system.

Karuk Judicial Center - Siskiyou County, Annual

Table Name	Column Name	Default Value	New Value
tblAreaMitigation	UseLowVOCPaintParkingCheck	False	True
tblConstDustMitigation	WaterUnpavedRoadVehicleSpeed	0	10
tblConstructionPhase	NumDays	100.00	5.00
tblConstructionPhase	NumDays	10.00	0.00
tblConstructionPhase	NumDays	5.00	1.00
tblConstructionPhase	PhaseEndDate	9/20/2021	4/20/2021
tblConstructionPhase	PhaseEndDate	9/6/2021	4/12/2021
tblConstructionPhase	PhaseEndDate	4/14/2021	3/31/2021
tblConstructionPhase	PhaseEndDate	4/19/2021	4/5/2021
tblConstructionPhase	PhaseEndDate	9/13/2021	4/13/2021
tblConstructionPhase	PhaseEndDate	4/15/2021	4/1/2021
tblConstructionPhase	PhaseStartDate	9/14/2021	4/14/2021
tblConstructionPhase	PhaseStartDate	4/20/2021	4/6/2021
tblConstructionPhase	PhaseStartDate	4/16/2021	4/2/2021
tblConstructionPhase	PhaseStartDate	9/7/2021	4/13/2021
tblConstructionPhase	PhaseStartDate	4/15/2021	4/1/2021
tblOffRoadEquipment	OffRoadEquipmentUnitAmount	1.00	0.00
tblOffRoadEquipment	OffRoadEquipmentUnitAmount	1.00	0.00
tblOffRoadEquipment	OffRoadEquipmentUnitAmount	2.00	0.00
tblRoadDust	MeanVehicleSpeed	40	10

2.0 Emissions Summary

Karuk Judicial Center - Siskiyou County, Annual

Quarter	Start Date	End Date	Maximum Unmitigated ROG + NOX (tons/quarter)	Maximum Mitigated ROG + NOX (tons/quarter)
1	4-1-2021	6-30-2021	0.0783	0.0783
		Highest	0.0783	0.0783

2.2 Overall Operational

Unmitigated Operational

	ROG	NOx	CO	SO2	Fugitive PM10	Exhaust PM10	PM10 Total	Fugitive PM2.5	Exhaust PM2.5	PM2.5 Total	Bio- CO2	NBio- CO2	Total CO2	CH4	N2O	CO2e
Category	tons/yr										MT/yr					
Area	0.0147	0.0000	1.4000e-004	0.0000		0.0000	0.0000		0.0000	0.0000	0.0000	2.6000e-004	2.6000e-004	0.0000	0.0000	2.8000e-004
Energy	3.0000e-004	2.6800e-003	2.2500e-003	2.0000e-005		2.0000e-004	2.0000e-004		2.0000e-004	2.0000e-004	0.0000	27.4489	27.4489	4.9000e-004	1.4000e-004	27.5035
Mobile	0.0650	0.5593	0.6083	1.9200e-003	0.0880	2.0900e-003	0.0901	0.0237	1.9700e-003	0.0257	0.0000	178.3584	178.3584	0.0159	0.0000	178.7560
Waste						0.0000	0.0000		0.0000	0.0000	0.5278	0.0000	0.5278	0.0312	0.0000	1.3075
Water						0.0000	0.0000		0.0000	0.0000	0.1765	3.1579	3.3344	0.0182	4.4000e-004	3.9198
Total	0.0800	0.5620	0.6107	1.9400e-003	0.0880	2.2900e-003	0.0903	0.0237	2.1700e-003	0.0259	0.7043	208.9655	209.6697	0.0658	5.8000e-004	211.4872

Karuk Judicial Center - Siskiyou County, Annual

2.2 Overall Operational

Mitigated Operational

	ROG	NOx	CO	SO2	Fugitive PM10	Exhaust PM10	PM10 Total	Fugitive PM2.5	Exhaust PM2.5	PM2.5 Total	Bio- CO2	NBio- CO2	Total CO2	CH4	N2O	CO2e
Category	tons/yr										MT/yr					
Area	0.0139	0.0000	1.4000e-004	0.0000		0.0000	0.0000		0.0000	0.0000	0.0000	2.6000e-004	2.6000e-004	0.0000	0.0000	2.8000e-004
Energy	3.0000e-004	2.6800e-003	2.2500e-003	2.0000e-005		2.0000e-004	2.0000e-004		2.0000e-004	2.0000e-004	0.0000	27.4489	27.4489	4.9000e-004	1.4000e-004	27.5035
Mobile	0.0650	0.5593	0.6083	1.9200e-003	0.0880	2.0900e-003	0.0901	0.0237	1.9700e-003	0.0257	0.0000	178.3584	178.3584	0.0159	0.0000	178.7560
Waste						0.0000	0.0000		0.0000	0.0000	0.5278	0.0000	0.5278	0.0312	0.0000	1.3075
Water						0.0000	0.0000		0.0000	0.0000	0.1412	2.6509	2.7921	0.0146	3.5000e-004	3.2607
Total	0.0792	0.5620	0.6107	1.9400e-003	0.0880	2.2900e-003	0.0903	0.0237	2.1700e-003	0.0259	0.6690	208.4585	209.1275	0.0621	4.9000e-004	210.8280

	ROG	NOx	CO	SO2	Fugitive PM10	Exhaust PM10	PM10 Total	Fugitive PM2.5	Exhaust PM2.5	PM2.5 Total	Bio- CO2	NBio-CO2	Total CO2	CH4	N2O	CO2e
Percent Reduction	1.03	0.00	0.00	0.00	0.00	0.00	0.00	0.00	0.00	0.00	5.01	0.24	0.26	5.52	15.52	0.31

3.0 Construction Detail

Construction Phase

Karuk Judicial Center - Siskiyou County, Annual

Phase Number	Phase Name	Phase Type	Start Date	End Date	Num Days Week	Num Days	Phase Description
1	Demolition	Demolition	4/1/2021	3/31/2021	5	0	
2	Site Preparation	Site Preparation	4/1/2021	4/1/2021	5	1	
3	Grading	Grading	4/2/2021	4/5/2021	5	2	
4	Building Construction	Building Construction	4/6/2021	4/12/2021	5	5	
5	Paving	Paving	4/13/2021	4/13/2021	5	1	
6	Architectural Coating	Architectural Coating	4/14/2021	4/20/2021	5	5	

Acres of Grading (Site Preparation Phase): 0.5

Acres of Grading (Grading Phase): 0

Acres of Paving: 0.11

Residential Indoor: 0; Residential Outdoor: 0; Non-Residential Indoor: 4,200; Non-Residential Outdoor: 1,400; Striped Parking Area: 288 (Architectural Coating – sqft)

OffRoad Equipment

Karuk Judicial Center - Siskiyou County, Annual

Phase Name	Offroad Equipment Type	Amount	Usage Hours	Horse Power	Load Factor
Architectural Coating	Air Compressors	1	6.00	78	0.48
Paving	Cement and Mortar Mixers	4	6.00	9	0.56
Demolition	Concrete/Industrial Saws	0	8.00	81	0.73
Grading	Concrete/Industrial Saws	1	8.00	81	0.73
Building Construction	Cranes	1	4.00	231	0.29
Building Construction	Forklifts	2	6.00	89	0.20
Site Preparation	Graders	1	8.00	187	0.41
Paving	Pavers	1	7.00	130	0.42
Paving	Rollers	1	7.00	80	0.38
Demolition	Rubber Tired Dozers	0	1.00	247	0.40
Grading	Rubber Tired Dozers	1	1.00	247	0.40
Building Construction	Tractors/Loaders/Backhoes	2	8.00	97	0.37
Demolition	Tractors/Loaders/Backhoes	0	6.00	97	0.37
Grading	Tractors/Loaders/Backhoes	2	6.00	97	0.37
Paving	Tractors/Loaders/Backhoes	1	7.00	97	0.37
Site Preparation	Tractors/Loaders/Backhoes	1	8.00	97	0.37

Trips and VMT

Phase Name	Offroad Equipment Count	Worker Trip Number	Vendor Trip Number	Hauling Trip Number	Worker Trip Length	Vendor Trip Length	Hauling Trip Length	Worker Vehicle Class	Vendor Vehicle Class	Hauling Vehicle Class
Demolition	0	0.00	0.00	0.00	10.80	7.30	20.00	LD_Mix	HDT_Mix	HHDT
Site Preparation	2	5.00	0.00	0.00	10.80	7.30	20.00	LD_Mix	HDT_Mix	HHDT
Grading	4	10.00	0.00	0.00	10.80	7.30	20.00	LD_Mix	HDT_Mix	HHDT
Building Construction	5	3.00	1.00	0.00	10.80	7.30	20.00	LD_Mix	HDT_Mix	HHDT
Paving	7	18.00	0.00	0.00	10.80	7.30	20.00	LD_Mix	HDT_Mix	HHDT
Architectural Coating	1	1.00	0.00	0.00	10.80	7.30	20.00	LD_Mix	HDT_Mix	HHDT

Karuk Judicial Center - Siskiyou County, Annual

3.2 Demolition - 2021

Mitigated Construction Off-Site

	ROG	NOx	CO	SO2	Fugitive PM10	Exhaust PM10	PM10 Total	Fugitive PM2.5	Exhaust PM2.5	PM2.5 Total	Bio- CO2	NBio- CO2	Total CO2	CH4	N2O	CO2e
Category	tons/yr										MT/yr					
Hauling	0.0000	0.0000	0.0000	0.0000	0.0000	0.0000	0.0000	0.0000	0.0000	0.0000	0.0000	0.0000	0.0000	0.0000	0.0000	0.0000
Vendor	0.0000	0.0000	0.0000	0.0000	0.0000	0.0000	0.0000	0.0000	0.0000	0.0000	0.0000	0.0000	0.0000	0.0000	0.0000	0.0000
Worker	0.0000	0.0000	0.0000	0.0000	0.0000	0.0000	0.0000	0.0000	0.0000	0.0000	0.0000	0.0000	0.0000	0.0000	0.0000	0.0000
Total	0.0000	0.0000	0.0000	0.0000	0.0000	0.0000	0.0000	0.0000	0.0000	0.0000	0.0000	0.0000	0.0000	0.0000	0.0000	0.0000

3.3 Site Preparation - 2021

Unmitigated Construction On-Site

	ROG	NOx	CO	SO2	Fugitive PM10	Exhaust PM10	PM10 Total	Fugitive PM2.5	Exhaust PM2.5	PM2.5 Total	Bio- CO2	NBio- CO2	Total CO2	CH4	N2O	CO2e
Category	tons/yr										MT/yr					
Fugitive Dust					2.7000e-004	0.0000	2.7000e-004	3.0000e-005	0.0000	3.0000e-005	0.0000	0.0000	0.0000	0.0000	0.0000	0.0000
Off-Road	3.2000e-004	3.9100e-003	2.0100e-003	0.0000		1.5000e-004	1.5000e-004		1.4000e-004	1.4000e-004	0.0000	0.4276	0.4276	1.4000e-004	0.0000	0.4310
Total	3.2000e-004	3.9100e-003	2.0100e-003	0.0000	2.7000e-004	1.5000e-004	4.2000e-004	3.0000e-005	1.4000e-004	1.7000e-004	0.0000	0.4276	0.4276	1.4000e-004	0.0000	0.4310

Karuk Judicial Center - Siskiyou County, Annual

3.3 Site Preparation - 2021

Unmitigated Construction Off-Site

	ROG	NOx	CO	SO2	Fugitive PM10	Exhaust PM10	PM10 Total	Fugitive PM2.5	Exhaust PM2.5	PM2.5 Total	Bio- CO2	NBio- CO2	Total CO2	CH4	N2O	CO2e
Category	tons/yr										MT/yr					
Hauling	0.0000	0.0000	0.0000	0.0000	0.0000	0.0000	0.0000	0.0000	0.0000	0.0000	0.0000	0.0000	0.0000	0.0000	0.0000	0.0000
Vendor	0.0000	0.0000	0.0000	0.0000	0.0000	0.0000	0.0000	0.0000	0.0000	0.0000	0.0000	0.0000	0.0000	0.0000	0.0000	0.0000
Worker	2.0000e-005	1.0000e-005	1.2000e-004	0.0000	2.0000e-005	0.0000	2.0000e-005	1.0000e-005	0.0000	1.0000e-005	0.0000	0.0191	0.0191	0.0000	0.0000	0.0191
Total	2.0000e-005	1.0000e-005	1.2000e-004	0.0000	2.0000e-005	0.0000	2.0000e-005	1.0000e-005	0.0000	1.0000e-005	0.0000	0.0191	0.0191	0.0000	0.0000	0.0191

Mitigated Construction On-Site

	ROG	NOx	CO	SO2	Fugitive PM10	Exhaust PM10	PM10 Total	Fugitive PM2.5	Exhaust PM2.5	PM2.5 Total	Bio- CO2	NBio- CO2	Total CO2	CH4	N2O	CO2e
Category	tons/yr										MT/yr					
Fugitive Dust					1.2000e-004	0.0000	1.2000e-004	1.0000e-005	0.0000	1.0000e-005	0.0000	0.0000	0.0000	0.0000	0.0000	0.0000
Off-Road	3.2000e-004	3.9100e-003	2.0100e-003	0.0000		1.5000e-004	1.5000e-004		1.4000e-004	1.4000e-004	0.0000	0.4276	0.4276	1.4000e-004	0.0000	0.4310
Total	3.2000e-004	3.9100e-003	2.0100e-003	0.0000	1.2000e-004	1.5000e-004	2.7000e-004	1.0000e-005	1.4000e-004	1.5000e-004	0.0000	0.4276	0.4276	1.4000e-004	0.0000	0.4310

Karuk Judicial Center - Siskiyou County, Annual

3.3 Site Preparation - 2021

Mitigated Construction Off-Site

	ROG	NOx	CO	SO2	Fugitive PM10	Exhaust PM10	PM10 Total	Fugitive PM2.5	Exhaust PM2.5	PM2.5 Total	Bio- CO2	NBio- CO2	Total CO2	CH4	N2O	CO2e
Category	tons/yr										MT/yr					
Hauling	0.0000	0.0000	0.0000	0.0000	0.0000	0.0000	0.0000	0.0000	0.0000	0.0000	0.0000	0.0000	0.0000	0.0000	0.0000	0.0000
Vendor	0.0000	0.0000	0.0000	0.0000	0.0000	0.0000	0.0000	0.0000	0.0000	0.0000	0.0000	0.0000	0.0000	0.0000	0.0000	0.0000
Worker	2.0000e-005	1.0000e-005	1.2000e-004	0.0000	2.0000e-005	0.0000	2.0000e-005	1.0000e-005	0.0000	1.0000e-005	0.0000	0.0191	0.0191	0.0000	0.0000	0.0191
Total	2.0000e-005	1.0000e-005	1.2000e-004	0.0000	2.0000e-005	0.0000	2.0000e-005	1.0000e-005	0.0000	1.0000e-005	0.0000	0.0191	0.0191	0.0000	0.0000	0.0191

3.4 Grading - 2021

Unmitigated Construction On-Site

	ROG	NOx	CO	SO2	Fugitive PM10	Exhaust PM10	PM10 Total	Fugitive PM2.5	Exhaust PM2.5	PM2.5 Total	Bio- CO2	NBio- CO2	Total CO2	CH4	N2O	CO2e
Category	tons/yr										MT/yr					
Fugitive Dust					7.5000e-004	0.0000	7.5000e-004	4.1000e-004	0.0000	4.1000e-004	0.0000	0.0000	0.0000	0.0000	0.0000	0.0000
Off-Road	8.0000e-004	7.2500e-003	7.5700e-003	1.0000e-005		4.1000e-004	4.1000e-004		3.9000e-004	3.9000e-004	0.0000	1.0409	1.0409	1.9000e-004	0.0000	1.0458
Total	8.0000e-004	7.2500e-003	7.5700e-003	1.0000e-005	7.5000e-004	4.1000e-004	1.1600e-003	4.1000e-004	3.9000e-004	8.0000e-004	0.0000	1.0409	1.0409	1.9000e-004	0.0000	1.0458

Karuk Judicial Center - Siskiyou County, Annual

3.4 Grading - 2021

Unmitigated Construction Off-Site

	ROG	NOx	CO	SO2	Fugitive PM10	Exhaust PM10	PM10 Total	Fugitive PM2.5	Exhaust PM2.5	PM2.5 Total	Bio- CO2	NBio- CO2	Total CO2	CH4	N2O	CO2e
Category	tons/yr										MT/yr					
Hauling	0.0000	0.0000	0.0000	0.0000	0.0000	0.0000	0.0000	0.0000	0.0000	0.0000	0.0000	0.0000	0.0000	0.0000	0.0000	0.0000
Vendor	0.0000	0.0000	0.0000	0.0000	0.0000	0.0000	0.0000	0.0000	0.0000	0.0000	0.0000	0.0000	0.0000	0.0000	0.0000	0.0000
Worker	7.0000e-005	5.0000e-005	4.7000e-004	0.0000	8.0000e-005	0.0000	8.0000e-005	2.0000e-005	0.0000	2.0000e-005	0.0000	0.0762	0.0762	0.0000	0.0000	0.0763
Total	7.0000e-005	5.0000e-005	4.7000e-004	0.0000	8.0000e-005	0.0000	8.0000e-005	2.0000e-005	0.0000	2.0000e-005	0.0000	0.0762	0.0762	0.0000	0.0000	0.0763

Mitigated Construction On-Site

	ROG	NOx	CO	SO2	Fugitive PM10	Exhaust PM10	PM10 Total	Fugitive PM2.5	Exhaust PM2.5	PM2.5 Total	Bio- CO2	NBio- CO2	Total CO2	CH4	N2O	CO2e
Category	tons/yr										MT/yr					
Fugitive Dust					3.4000e-004	0.0000	3.4000e-004	1.9000e-004	0.0000	1.9000e-004	0.0000	0.0000	0.0000	0.0000	0.0000	0.0000
Off-Road	8.0000e-004	7.2500e-003	7.5700e-003	1.0000e-005		4.1000e-004	4.1000e-004		3.9000e-004	3.9000e-004	0.0000	1.0409	1.0409	1.9000e-004	0.0000	1.0458
Total	8.0000e-004	7.2500e-003	7.5700e-003	1.0000e-005	3.4000e-004	4.1000e-004	7.5000e-004	1.9000e-004	3.9000e-004	5.8000e-004	0.0000	1.0409	1.0409	1.9000e-004	0.0000	1.0458

Karuk Judicial Center - Siskiyou County, Annual

3.4 Grading - 2021

Mitigated Construction Off-Site

	ROG	NOx	CO	SO2	Fugitive PM10	Exhaust PM10	PM10 Total	Fugitive PM2.5	Exhaust PM2.5	PM2.5 Total	Bio- CO2	NBio- CO2	Total CO2	CH4	N2O	CO2e
Category	tons/yr										MT/yr					
Hauling	0.0000	0.0000	0.0000	0.0000	0.0000	0.0000	0.0000	0.0000	0.0000	0.0000	0.0000	0.0000	0.0000	0.0000	0.0000	0.0000
Vendor	0.0000	0.0000	0.0000	0.0000	0.0000	0.0000	0.0000	0.0000	0.0000	0.0000	0.0000	0.0000	0.0000	0.0000	0.0000	0.0000
Worker	7.0000e-005	5.0000e-005	4.7000e-004	0.0000	8.0000e-005	0.0000	8.0000e-005	2.0000e-005	0.0000	2.0000e-005	0.0000	0.0762	0.0762	0.0000	0.0000	0.0763
Total	7.0000e-005	5.0000e-005	4.7000e-004	0.0000	8.0000e-005	0.0000	8.0000e-005	2.0000e-005	0.0000	2.0000e-005	0.0000	0.0762	0.0762	0.0000	0.0000	0.0763

3.5 Building Construction - 2021

Unmitigated Construction On-Site

	ROG	NOx	CO	SO2	Fugitive PM10	Exhaust PM10	PM10 Total	Fugitive PM2.5	Exhaust PM2.5	PM2.5 Total	Bio- CO2	NBio- CO2	Total CO2	CH4	N2O	CO2e
Category	tons/yr										MT/yr					
Off-Road	1.9400e-003	0.0200	0.0182	3.0000e-005		1.1200e-003	1.1200e-003		1.0300e-003	1.0300e-003	0.0000	2.5021	2.5021	8.1000e-004	0.0000	2.5223
Total	1.9400e-003	0.0200	0.0182	3.0000e-005		1.1200e-003	1.1200e-003		1.0300e-003	1.0300e-003	0.0000	2.5021	2.5021	8.1000e-004	0.0000	2.5223

Karuk Judicial Center - Siskiyou County, Annual

3.5 Building Construction - 2021

Unmitigated Construction Off-Site

	ROG	NOx	CO	SO2	Fugitive PM10	Exhaust PM10	PM10 Total	Fugitive PM2.5	Exhaust PM2.5	PM2.5 Total	Bio- CO2	NBio- CO2	Total CO2	CH4	N2O	CO2e
Category	tons/yr										MT/yr					
Hauling	0.0000	0.0000	0.0000	0.0000	0.0000	0.0000	0.0000	0.0000	0.0000	0.0000	0.0000	0.0000	0.0000	0.0000	0.0000	0.0000
Vendor	1.0000e-005	3.0000e-004	9.0000e-005	0.0000	2.0000e-005	0.0000	2.0000e-005	0.0000	0.0000	1.0000e-005	0.0000	0.0733	0.0733	1.0000e-005	0.0000	0.0734
Worker	5.0000e-005	4.0000e-005	3.5000e-004	0.0000	6.0000e-005	0.0000	6.0000e-005	2.0000e-005	0.0000	2.0000e-005	0.0000	0.0572	0.0572	0.0000	0.0000	0.0572
Total	6.0000e-005	3.4000e-004	4.4000e-004	0.0000	8.0000e-005	0.0000	8.0000e-005	2.0000e-005	0.0000	3.0000e-005	0.0000	0.1305	0.1305	1.0000e-005	0.0000	0.1307

Mitigated Construction On-Site

	ROG	NOx	CO	SO2	Fugitive PM10	Exhaust PM10	PM10 Total	Fugitive PM2.5	Exhaust PM2.5	PM2.5 Total	Bio- CO2	NBio- CO2	Total CO2	CH4	N2O	CO2e
Category	tons/yr										MT/yr					
Off-Road	1.9400e-003	0.0200	0.0182	3.0000e-005		1.1200e-003	1.1200e-003		1.0300e-003	1.0300e-003	0.0000	2.5021	2.5021	8.1000e-004	0.0000	2.5223
Total	1.9400e-003	0.0200	0.0182	3.0000e-005		1.1200e-003	1.1200e-003		1.0300e-003	1.0300e-003	0.0000	2.5021	2.5021	8.1000e-004	0.0000	2.5223

Karuk Judicial Center - Siskiyou County, Annual

3.5 Building Construction - 2021

Mitigated Construction Off-Site

	ROG	NOx	CO	SO2	Fugitive PM10	Exhaust PM10	PM10 Total	Fugitive PM2.5	Exhaust PM2.5	PM2.5 Total	Bio- CO2	NBio- CO2	Total CO2	CH4	N2O	CO2e
Category	tons/yr										MT/yr					
Hauling	0.0000	0.0000	0.0000	0.0000	0.0000	0.0000	0.0000	0.0000	0.0000	0.0000	0.0000	0.0000	0.0000	0.0000	0.0000	0.0000
Vendor	1.0000e-005	3.0000e-004	9.0000e-005	0.0000	2.0000e-005	0.0000	2.0000e-005	0.0000	0.0000	1.0000e-005	0.0000	0.0733	0.0733	1.0000e-005	0.0000	0.0734
Worker	5.0000e-005	4.0000e-005	3.5000e-004	0.0000	6.0000e-005	0.0000	6.0000e-005	2.0000e-005	0.0000	2.0000e-005	0.0000	0.0572	0.0572	0.0000	0.0000	0.0572
Total	6.0000e-005	3.4000e-004	4.4000e-004	0.0000	8.0000e-005	0.0000	8.0000e-005	2.0000e-005	0.0000	3.0000e-005	0.0000	0.1305	0.1305	1.0000e-005	0.0000	0.1307

3.6 Paving - 2021

Unmitigated Construction On-Site

	ROG	NOx	CO	SO2	Fugitive PM10	Exhaust PM10	PM10 Total	Fugitive PM2.5	Exhaust PM2.5	PM2.5 Total	Bio- CO2	NBio- CO2	Total CO2	CH4	N2O	CO2e
Category	tons/yr										MT/yr					
Off-Road	3.6000e-004	3.3600e-003	3.5400e-003	1.0000e-005		1.8000e-004	1.8000e-004		1.6000e-004	1.6000e-004	0.0000	0.4696	0.4696	1.4000e-004	0.0000	0.4730
Paving	1.4000e-004					0.0000	0.0000		0.0000	0.0000	0.0000	0.0000	0.0000	0.0000	0.0000	0.0000
Total	5.0000e-004	3.3600e-003	3.5400e-003	1.0000e-005		1.8000e-004	1.8000e-004		1.6000e-004	1.6000e-004	0.0000	0.4696	0.4696	1.4000e-004	0.0000	0.4730

Karuk Judicial Center - Siskiyou County, Annual

3.6 Paving - 2021

Unmitigated Construction Off-Site

	ROG	NOx	CO	SO2	Fugitive PM10	Exhaust PM10	PM10 Total	Fugitive PM2.5	Exhaust PM2.5	PM2.5 Total	Bio- CO2	NBio- CO2	Total CO2	CH4	N2O	CO2e
Category	tons/yr										MT/yr					
Hauling	0.0000	0.0000	0.0000	0.0000	0.0000	0.0000	0.0000	0.0000	0.0000	0.0000	0.0000	0.0000	0.0000	0.0000	0.0000	0.0000
Vendor	0.0000	0.0000	0.0000	0.0000	0.0000	0.0000	0.0000	0.0000	0.0000	0.0000	0.0000	0.0000	0.0000	0.0000	0.0000	0.0000
Worker	6.0000e-005	5.0000e-005	4.2000e-004	0.0000	7.0000e-005	0.0000	7.0000e-005	2.0000e-005	0.0000	2.0000e-005	0.0000	0.0686	0.0686	0.0000	0.0000	0.0687
Total	6.0000e-005	5.0000e-005	4.2000e-004	0.0000	7.0000e-005	0.0000	7.0000e-005	2.0000e-005	0.0000	2.0000e-005	0.0000	0.0686	0.0686	0.0000	0.0000	0.0687

Mitigated Construction On-Site

	ROG	NOx	CO	SO2	Fugitive PM10	Exhaust PM10	PM10 Total	Fugitive PM2.5	Exhaust PM2.5	PM2.5 Total	Bio- CO2	NBio- CO2	Total CO2	CH4	N2O	CO2e
Category	tons/yr										MT/yr					
Off-Road	3.6000e-004	3.3600e-003	3.5400e-003	1.0000e-005		1.8000e-004	1.8000e-004		1.6000e-004	1.6000e-004	0.0000	0.4696	0.4696	1.4000e-004	0.0000	0.4730
Paving	1.4000e-004					0.0000	0.0000		0.0000	0.0000	0.0000	0.0000	0.0000	0.0000	0.0000	0.0000
Total	5.0000e-004	3.3600e-003	3.5400e-003	1.0000e-005		1.8000e-004	1.8000e-004		1.6000e-004	1.6000e-004	0.0000	0.4696	0.4696	1.4000e-004	0.0000	0.4730

Karuk Judicial Center - Siskiyou County, Annual

3.6 Paving - 2021

Mitigated Construction Off-Site

	ROG	NOx	CO	SO2	Fugitive PM10	Exhaust PM10	PM10 Total	Fugitive PM2.5	Exhaust PM2.5	PM2.5 Total	Bio- CO2	NBio- CO2	Total CO2	CH4	N2O	CO2e
Category	tons/yr										MT/yr					
Hauling	0.0000	0.0000	0.0000	0.0000	0.0000	0.0000	0.0000	0.0000	0.0000	0.0000	0.0000	0.0000	0.0000	0.0000	0.0000	0.0000
Vendor	0.0000	0.0000	0.0000	0.0000	0.0000	0.0000	0.0000	0.0000	0.0000	0.0000	0.0000	0.0000	0.0000	0.0000	0.0000	0.0000
Worker	6.0000e-005	5.0000e-005	4.2000e-004	0.0000	7.0000e-005	0.0000	7.0000e-005	2.0000e-005	0.0000	2.0000e-005	0.0000	0.0686	0.0686	0.0000	0.0000	0.0687
Total	6.0000e-005	5.0000e-005	4.2000e-004	0.0000	7.0000e-005	0.0000	7.0000e-005	2.0000e-005	0.0000	2.0000e-005	0.0000	0.0686	0.0686	0.0000	0.0000	0.0687

3.7 Architectural Coating - 2021

Unmitigated Construction On-Site

	ROG	NOx	CO	SO2	Fugitive PM10	Exhaust PM10	PM10 Total	Fugitive PM2.5	Exhaust PM2.5	PM2.5 Total	Bio- CO2	NBio- CO2	Total CO2	CH4	N2O	CO2e
Category	tons/yr										MT/yr					
Archit. Coating	0.0341					0.0000	0.0000		0.0000	0.0000	0.0000	0.0000	0.0000	0.0000	0.0000	0.0000
Off-Road	5.5000e-004	3.8200e-003	4.5400e-003	1.0000e-005		2.4000e-004	2.4000e-004		2.4000e-004	2.4000e-004	0.0000	0.6383	0.6383	4.0000e-005	0.0000	0.6394
Total	0.0347	3.8200e-003	4.5400e-003	1.0000e-005		2.4000e-004	2.4000e-004		2.4000e-004	2.4000e-004	0.0000	0.6383	0.6383	4.0000e-005	0.0000	0.6394

Karuk Judicial Center - Siskiyou County, Annual

3.7 Architectural Coating - 2021

Unmitigated Construction Off-Site

	ROG	NOx	CO	SO2	Fugitive PM10	Exhaust PM10	PM10 Total	Fugitive PM2.5	Exhaust PM2.5	PM2.5 Total	Bio- CO2	NBio- CO2	Total CO2	CH4	N2O	CO2e
Category	tons/yr										MT/yr					
Hauling	0.0000	0.0000	0.0000	0.0000	0.0000	0.0000	0.0000	0.0000	0.0000	0.0000	0.0000	0.0000	0.0000	0.0000	0.0000	0.0000
Vendor	0.0000	0.0000	0.0000	0.0000	0.0000	0.0000	0.0000	0.0000	0.0000	0.0000	0.0000	0.0000	0.0000	0.0000	0.0000	0.0000
Worker	2.0000e-005	1.0000e-005	1.2000e-004	0.0000	2.0000e-005	0.0000	2.0000e-005	1.0000e-005	0.0000	1.0000e-005	0.0000	0.0191	0.0191	0.0000	0.0000	0.0191
Total	2.0000e-005	1.0000e-005	1.2000e-004	0.0000	2.0000e-005	0.0000	2.0000e-005	1.0000e-005	0.0000	1.0000e-005	0.0000	0.0191	0.0191	0.0000	0.0000	0.0191

Mitigated Construction On-Site

	ROG	NOx	CO	SO2	Fugitive PM10	Exhaust PM10	PM10 Total	Fugitive PM2.5	Exhaust PM2.5	PM2.5 Total	Bio- CO2	NBio- CO2	Total CO2	CH4	N2O	CO2e
Category	tons/yr										MT/yr					
Archit. Coating	0.0341					0.0000	0.0000		0.0000	0.0000	0.0000	0.0000	0.0000	0.0000	0.0000	0.0000
Off-Road	5.5000e-004	3.8200e-003	4.5400e-003	1.0000e-005		2.4000e-004	2.4000e-004		2.4000e-004	2.4000e-004	0.0000	0.6383	0.6383	4.0000e-005	0.0000	0.6394
Total	0.0347	3.8200e-003	4.5400e-003	1.0000e-005		2.4000e-004	2.4000e-004		2.4000e-004	2.4000e-004	0.0000	0.6383	0.6383	4.0000e-005	0.0000	0.6394

Karuk Judicial Center - Siskiyou County, Annual

3.7 Architectural Coating - 2021

Mitigated Construction Off-Site

	ROG	NOx	CO	SO2	Fugitive PM10	Exhaust PM10	PM10 Total	Fugitive PM2.5	Exhaust PM2.5	PM2.5 Total	Bio- CO2	NBio- CO2	Total CO2	CH4	N2O	CO2e
Category	tons/yr										MT/yr					
Hauling	0.0000	0.0000	0.0000	0.0000	0.0000	0.0000	0.0000	0.0000	0.0000	0.0000	0.0000	0.0000	0.0000	0.0000	0.0000	0.0000
Vendor	0.0000	0.0000	0.0000	0.0000	0.0000	0.0000	0.0000	0.0000	0.0000	0.0000	0.0000	0.0000	0.0000	0.0000	0.0000	0.0000
Worker	2.0000e-005	1.0000e-005	1.2000e-004	0.0000	2.0000e-005	0.0000	2.0000e-005	1.0000e-005	0.0000	1.0000e-005	0.0000	0.0191	0.0191	0.0000	0.0000	0.0191
Total	2.0000e-005	1.0000e-005	1.2000e-004	0.0000	2.0000e-005	0.0000	2.0000e-005	1.0000e-005	0.0000	1.0000e-005	0.0000	0.0191	0.0191	0.0000	0.0000	0.0191

4.0 Operational Detail - Mobile

4.1 Mitigation Measures Mobile

Karuk Judicial Center - Siskiyou County, Annual

	ROG	NOx	CO	SO2	Fugitive PM10	Exhaust PM10	PM10 Total	Fugitive PM2.5	Exhaust PM2.5	PM2.5 Total	Bio- CO2	NBio- CO2	Total CO2	CH4	N2O	CO2e
Category	tons/yr										MT/yr					
Mitigated	0.0650	0.5593	0.6083	1.9200e-003	0.0880	2.0900e-003	0.0901	0.0237	1.9700e-003	0.0257	0.0000	178.3584	178.3584	0.0159	0.0000	178.7560
Unmitigated	0.0650	0.5593	0.6083	1.9200e-003	0.0880	2.0900e-003	0.0901	0.0237	1.9700e-003	0.0257	0.0000	178.3584	178.3584	0.0159	0.0000	178.7560

4.2 Trip Summary Information

Land Use	Average Daily Trip Rate			Unmitigated	Mitigated
	Weekday	Saturday	Sunday	Annual VMT	Annual VMT
Government Office Building	193.00	0.00	0.00	236,413	236,413
Parking Lot	0.00	0.00	0.00		
Total	193.00	0.00	0.00	236,413	236,413

4.3 Trip Type Information

Land Use	Miles			Trip %			Trip Purpose %		
	H-W or C-W	H-S or C-C	H-O or C-NW	H-W or C-W	H-S or C-C	H-O or C-NW	Primary	Diverted	Pass-by
Government Office Building	9.50	7.30	7.30	33.00	62.00	5.00	50	34	16
Parking Lot	9.50	7.30	7.30	0.00	0.00	0.00	0	0	0

4.4 Fleet Mix

Land Use	LDA	LDT1	LDT2	MDV	LHD1	LHD2	MHD	HHD	OBUS	UBUS	MCY	SBUS	MH
Government Office Building	0.487361	0.038770	0.180029	0.116952	0.034202	0.006373	0.008681	0.117611	0.001222	0.001581	0.005079	0.001001	0.001137
Parking Lot	0.487361	0.038770	0.180029	0.116952	0.034202	0.006373	0.008681	0.117611	0.001222	0.001581	0.005079	0.001001	0.001137

Karuk Judicial Center - Siskiyou County, Annual

5.0 Energy Detail

Historical Energy Use: N

5.1 Mitigation Measures Energy

Install High Efficiency Lighting

	ROG	NOx	CO	SO2	Fugitive PM10	Exhaust PM10	PM10 Total	Fugitive PM2.5	Exhaust PM2.5	PM2.5 Total	Bio- CO2	NBio- CO2	Total CO2	CH4	N2O	CO2e
Category	tons/yr										MT/yr					
Electricity Mitigated						0.0000	0.0000		0.0000	0.0000	0.0000	24.5293	24.5293	4.3000e-004	9.0000e-005	24.5665
Electricity Unmitigated						0.0000	0.0000		0.0000	0.0000	0.0000	24.5293	24.5293	4.3000e-004	9.0000e-005	24.5665
NaturalGas Mitigated	3.0000e-004	2.6800e-003	2.2500e-003	2.0000e-005		2.0000e-004	2.0000e-004		2.0000e-004	2.0000e-004	0.0000	2.9196	2.9196	6.0000e-005	5.0000e-005	2.9370
NaturalGas Unmitigated	3.0000e-004	2.6800e-003	2.2500e-003	2.0000e-005		2.0000e-004	2.0000e-004		2.0000e-004	2.0000e-004	0.0000	2.9196	2.9196	6.0000e-005	5.0000e-005	2.9370

Karuk Judicial Center - Siskiyou County, Annual

5.2 Energy by Land Use - NaturalGas

Unmitigated

	NaturalGas Use	ROG	NOx	CO	SO2	Fugitive PM10	Exhaust PM10	PM10 Total	Fugitive PM2.5	Exhaust PM2.5	PM2.5 Total	Bio- CO2	NBio- CO2	Total CO2	CH4	N2O	CO2e
Land Use	kBTU/yr	tons/yr										MT/yr					
Government Office Building	54712	3.0000e-004	2.6800e-003	2.2500e-003	2.0000e-005		2.0000e-004	2.0000e-004		2.0000e-004	2.0000e-004	0.0000	2.9196	2.9196	6.0000e-005	5.0000e-005	2.9370
Parking Lot	0	0.0000	0.0000	0.0000	0.0000		0.0000	0.0000		0.0000	0.0000	0.0000	0.0000	0.0000	0.0000	0.0000	0.0000
Total		3.0000e-004	2.6800e-003	2.2500e-003	2.0000e-005		2.0000e-004	2.0000e-004		2.0000e-004	2.0000e-004	0.0000	2.9196	2.9196	6.0000e-005	5.0000e-005	2.9370

Mitigated

	NaturalGas Use	ROG	NOx	CO	SO2	Fugitive PM10	Exhaust PM10	PM10 Total	Fugitive PM2.5	Exhaust PM2.5	PM2.5 Total	Bio- CO2	NBio- CO2	Total CO2	CH4	N2O	CO2e
Land Use	kBTU/yr	tons/yr										MT/yr					
Government Office Building	54712	3.0000e-004	2.6800e-003	2.2500e-003	2.0000e-005		2.0000e-004	2.0000e-004		2.0000e-004	2.0000e-004	0.0000	2.9196	2.9196	6.0000e-005	5.0000e-005	2.9370
Parking Lot	0	0.0000	0.0000	0.0000	0.0000		0.0000	0.0000		0.0000	0.0000	0.0000	0.0000	0.0000	0.0000	0.0000	0.0000
Total		3.0000e-004	2.6800e-003	2.2500e-003	2.0000e-005		2.0000e-004	2.0000e-004		2.0000e-004	2.0000e-004	0.0000	2.9196	2.9196	6.0000e-005	5.0000e-005	2.9370

Karuk Judicial Center - Siskiyou County, Annual

5.3 Energy by Land Use - Electricity

Unmitigated

	Electricity Use	Total CO2	CH4	N2O	CO2e
Land Use	kWh/yr	MT/yr			
Government Office Building	30968	23.2671	4.1000e-004	8.0000e-005	23.3024
Parking Lot	1680	1.2622	2.0000e-005	0.0000	1.2641
Total		24.5293	4.3000e-004	8.0000e-005	24.5665

Mitigated

	Electricity Use	Total CO2	CH4	N2O	CO2e
Land Use	kWh/yr	MT/yr			
Government Office Building	30968	23.2671	4.1000e-004	8.0000e-005	23.3024
Parking Lot	1680	1.2622	2.0000e-005	0.0000	1.2641
Total		24.5293	4.3000e-004	8.0000e-005	24.5665

6.0 Area Detail

6.1 Mitigation Measures Area

Karuk Judicial Center - Siskiyou County, Annual

Use Low VOC Paint - Non-Residential Interior

Use Low VOC Paint - Non-Residential Exterior

No Hearths Installed

Use Low VOC Cleaning Supplies

	ROG	NOx	CO	SO2	Fugitive PM10	Exhaust PM10	PM10 Total	Fugitive PM2.5	Exhaust PM2.5	PM2.5 Total	Bio- CO2	NBio- CO2	Total CO2	CH4	N2O	CO2e
Category	tons/yr										MT/yr					
Mitigated	0.0139	0.0000	1.4000e-004	0.0000		0.0000	0.0000		0.0000	0.0000	0.0000	2.6000e-004	2.6000e-004	0.0000	0.0000	2.8000e-004
Unmitigated	0.0147	0.0000	1.4000e-004	0.0000		0.0000	0.0000		0.0000	0.0000	0.0000	2.6000e-004	2.6000e-004	0.0000	0.0000	2.8000e-004

Karuk Judicial Center - Siskiyou County, Annual

6.2 Area by SubCategory

Unmitigated

	ROG	NOx	CO	SO2	Fugitive PM10	Exhaust PM10	PM10 Total	Fugitive PM2.5	Exhaust PM2.5	PM2.5 Total	Bio- CO2	NBio- CO2	Total CO2	CH4	N2O	CO2e
SubCategory	tons/yr										MT/yr					
Architectural Coating	3.4100e-003					0.0000	0.0000		0.0000	0.0000	0.0000	0.0000	0.0000	0.0000	0.0000	0.0000
Consumer Products	0.0113					0.0000	0.0000		0.0000	0.0000	0.0000	0.0000	0.0000	0.0000	0.0000	0.0000
Landscaping	1.0000e-005	0.0000	1.4000e-004	0.0000		0.0000	0.0000		0.0000	0.0000	0.0000	2.6000e-004	2.6000e-004	0.0000	0.0000	2.8000e-004
Total	0.0147	0.0000	1.4000e-004	0.0000		0.0000	0.0000		0.0000	0.0000	0.0000	2.6000e-004	2.6000e-004	0.0000	0.0000	2.8000e-004

Mitigated

	ROG	NOx	CO	SO2	Fugitive PM10	Exhaust PM10	PM10 Total	Fugitive PM2.5	Exhaust PM2.5	PM2.5 Total	Bio- CO2	NBio- CO2	Total CO2	CH4	N2O	CO2e
SubCategory	tons/yr										MT/yr					
Architectural Coating	3.4100e-003					0.0000	0.0000		0.0000	0.0000	0.0000	0.0000	0.0000	0.0000	0.0000	0.0000
Consumer Products	0.0104					0.0000	0.0000		0.0000	0.0000	0.0000	0.0000	0.0000	0.0000	0.0000	0.0000
Landscaping	1.0000e-005	0.0000	1.4000e-004	0.0000		0.0000	0.0000		0.0000	0.0000	0.0000	2.6000e-004	2.6000e-004	0.0000	0.0000	2.8000e-004
Total	0.0139	0.0000	1.4000e-004	0.0000		0.0000	0.0000		0.0000	0.0000	0.0000	2.6000e-004	2.6000e-004	0.0000	0.0000	2.8000e-004

7.0 Water Detail

Karuk Judicial Center - Siskiyou County, Annual

7.1 Mitigation Measures Water

Install Low Flow Bathroom Faucet

Install Low Flow Kitchen Faucet

Install Low Flow Toilet

Install Low Flow Shower

Use Water Efficient Irrigation System

Use Water Efficient Landscaping

	Total CO2	CH4	N2O	CO2e
Category	MT/yr			
Mitigated	2.7921	0.0146	3.5000e-004	3.2607
Unmitigated	3.3344	0.0182	4.4000e-004	3.9198

Karuk Judicial Center - Siskiyou County, Annual

7.2 Water by Land Use

Unmitigated

	Indoor/Outdoor Use	Total CO2	CH4	N2O	CO2e
Land Use	Mgal	MT/yr			
Government Office Building	0.556247 / 0.340926	3.3344	0.0182	4.4000e-004	3.9198
Parking Lot	0 / 0	0.0000	0.0000	0.0000	0.0000
Total		3.3344	0.0182	4.4000e-004	3.9198

Mitigated

	Indoor/Outdoor Use	Total CO2	CH4	N2O	CO2e
Land Use	Mgal	MT/yr			
Government Office Building	0.444998 / 0.320129	2.7921	0.0146	3.5000e-004	3.2607
Parking Lot	0 / 0	0.0000	0.0000	0.0000	0.0000
Total		2.7921	0.0146	3.5000e-004	3.2607

8.0 Waste Detail

8.1 Mitigation Measures Waste

Karuk Judicial Center - Siskiyou County, Annual

Category/Year

	Total CO2	CH4	N2O	CO2e
	MT/yr			
Mitigated	0.5278	0.0312	0.0000	1.3075
Unmitigated	0.5278	0.0312	0.0000	1.3075

8.2 Waste by Land Use

Unmitigated

	Waste Disposed	Total CO2	CH4	N2O	CO2e
Land Use	tons	MT/yr			
Government Office Building	2.6	0.5278	0.0312	0.0000	1.3075
Parking Lot	0	0.0000	0.0000	0.0000	0.0000
Total		0.5278	0.0312	0.0000	1.3075

Karuk Judicial Center - Siskiyou County, Annual

8.2 Waste by Land Use

Mitigated

	Waste Disposed	Total CO2	CH4	N2O	CO2e
Land Use	tons	MT/yr			
Government Office Building	2.6	0.5278	0.0312	0.0000	1.3075
Parking Lot	0	0.0000	0.0000	0.0000	0.0000
Total		0.5278	0.0312	0.0000	1.3075

9.0 Operational Offroad

Equipment Type	Number	Hours/Day	Days/Year	Horse Power	Load Factor	Fuel Type
----------------	--------	-----------	-----------	-------------	-------------	-----------

10.0 Stationary Equipment

Fire Pumps and Emergency Generators

Equipment Type	Number	Hours/Day	Hours/Year	Horse Power	Load Factor	Fuel Type
----------------	--------	-----------	------------	-------------	-------------	-----------

Boilers

Equipment Type	Number	Heat Input/Day	Heat Input/Year	Boiler Rating	Fuel Type
----------------	--------	----------------	-----------------	---------------	-----------

User Defined Equipment

Equipment Type	Number
----------------	--------

11.0 Vegetation

APPENDIX F
Finding of No Significant Impact (To be Developed)